



 ANNUAL
HOMECOMING

November 7-9, 2010

Hyland Heights Baptist Church
Lynchburg

Transforming
LIVES



HOMECOMING GUIDE

Transforming LIVES

Table of Contents

Annual Homecoming Program	2
Program Personalities	5
Breakout Seminars	8
Annual Homecoming Events	10
Hyland Heights Baptist Church Facilities	11
Exhibits	13
State Missions Team	14
Executive Board	15
Minutes of 2009 Annual Meeting	16
Executive Director–Treasurer’s Report	31
Treasurer’s Report	33
Proposed 2011 Ministry Investment Plan	35
Maturing Churches Report	40
Multiplying Churches Report	44
Mobilizing Churches Report	46
CP Contributions Comparison	50
2010 Vision 20/20 Report	69
Church Affiliation Report	72
Nominating Committee Report	74
Business and Ministry Plan	76

2010 Homecoming Program

Sunday, Nov. 7 — Tuesday, Nov. 9

Sunday Evening

- 6:30 Praise & Worship: Convention Praise Team
6:40 Host Church Choir: Hyland Heights Baptist Church
6:45 Welcome: Dr. Mark Becton
Greeting and Prayer from Host Pastor: Rev. Carl Weiser
6:52 Special Music: Hyland Heights Baptist Church
7:00 Theme Challenge: Rev. Jonge Tate
7:10 Praise & Worship: Convention Praise Team
7:20 Intro and Prayer: Dr. Bryan Smith
7:22 Special Music: Hyland Heights Baptist Church
7:30 President's Message: Dr. Mark Becton
8:10 Time of Reflection: Convention Praise Team
8:20 Announcements: Dr. Mark Becton
8:30 Benediction: Rev. Carlos Payan
8:45 Southern Baptist Convention Q&A with Dr. Jeff Ginn



Mark Becton

Dr. Mark Becton is senior pastor of Grove Avenue Baptist Church in Richmond and president of the Southern Baptist Conservatives of Virginia. He received his Master of Divinity and Doctor of Philosophy from Southwestern Baptist Theological Seminary. He has served in pastorates for more than twenty years and has served as a member of the Committee on Committees (Southern Baptist Convention) and charter member of the Presidents Council (National Religious Broadcasters).

Monday Morning

- 9:00 Praise & Worship: Convention Praise Team
9:10 Welcome: Dr. Mark Becton
Prayer: Rev. Danny Campbell
9:15 Breakout Seminar 1
10:30 Breakout Seminar 2
11:30 Dismiss
11:45 Seminary Luncheons

Monday Afternoon

- 1:30 Concert: LU Center for Worship Choir with Charles Billingsley
1:40 SBCV 360° Video
Welcome: Dr. Mark Becton
Prayer: Rev. Ed Taylor
1:45 Praise & Worship: Convention Praise Team
1:55 Prayer for America: Rev. David Andersen
2:00 Special Music: Dr. Leo Day
2:10 Theme Focus Video
2:15 Call to Order

Introduction of Business and Reports:

Approval of 2009 Annual Meeting Minutes

Executive Director-Treasurer's Report: Dr. Jeff Ginn

Special Recognition: *Macedonia Awards for CP Giving*

Executive Board Recommendations:

1. Vision 20/20 Steering Team Report: Rev. Carl Weiser, Chairman of Vision 20/20 Steering Team
2. Affiliation Requests: Rev. Robert Rowland, Chairman of

Maturing Churches Committee

3. Ministry Investment Plan: Dr. Doyle Chauncey, Assistant Treasurer
 4. Nominating Committee Report: Dr. Kelly Burris, Chairman of Nominating Committee
- 3:05 Praise & Worship: LU Center for Worship Choir
 3:15 Seminary Recognitions
 3:25 Prayer: Rev. Brandon Hembree
 3:32 Special Music: Dr. Leo Day
 3:35 Theme Challenge: Rev. Banks Swanson
 3:45 Praise & Worship: Convention Praise Team
 3:53 Intro and Prayer: Rev. Bill Wennersten
 3:55 Message: Rev. Jeff Crook
 4:25 Time of Reflection: Convention Praise Team
 4:30 Announcements: Affinity Dinners
 4:33 Benediction: Rev. Nashaat Ibrahim



Jeff Crook

Rev. Jeff Crook is the Senior Pastor of Blackshear Place Baptist Church, Flowery Branch, Georgia. Their current membership is 7,000 with an average Sunday attendance of 2,800. Blackshear Place has welcomed over 3,100 new members (1,800 by Believer's Baptism) since 2004, under Pastor Jeff's leadership. He is a graduate of The Baptist College of Florida and the New Orleans Baptist Seminary.

Monday Evening

- 6:45 Concert: Dr. Leo Day
 7:00 SBCV 360° Video
 Welcome: 1st VP—Rev. Randy Green
 Prayer: Rev. John Koch
 7:05 Theme Challenge: Dr. Tim Piland
 7:10 Praise & Worship: Convention Praise Team
 7:20 State Ministry Report 1: *Maturing Churches*: Rev. Steve Bradshaw
 7:30 Special Recognition: *Pentecost Awards for Baptisms*: Dr. Jeff Ginn
 7:35 Special Music: Mass Choirs and Convention Praise Team, led by David Dalton
 7:50 Intro and Prayer: Rev. Chris Gill
 7:52 Special Music: Dr. Leo Day
 7:55 Message: Dr. J. D. Greear
 8:30 Time of Reflection: Convention Praise Team
 8:35 Announcements: Dr. Mark Becton
 8:37 Closing Prayer: Rev. Reggie Hester



J. D. Greear

Dr. J.D. Greear did his degree work in Christian and Islamic theology at Southeastern Baptist Theological Seminary. He now pastors a rapidly growing church of 4,000. J.D. is committed to the local church and to church planting, having undertaken the goal of planting 1000 churches in the next 40 years. Currently, they have 12 plants around the world. He has authored a number of publications, including *Breaking the Islam Code*.

Tuesday Morning

- 9:00 Praise & Worship: Convention Praise Team, Rev. Paul Randlett
- 9:10 Special Music: Dr. Leo Day
- 9:20 SBCV 360° Video
Welcome: 2nd VP—Rev. Neal Hawks
Prayer: Rev. Henry Amedeker
- 9:25 Call to Order and Business: Dr. Mark Becton
Executive Board Report: Rev. Carl Weiser, Chairman of the Executive Board
Resolutions Committee Report: Rev. Paul Davis, Jr., Chairman of the Resolutions Committee
- 10:00 Praise & Worship: Convention Praise Team
- 10:08 Intro and Prayer: Rev. Ron Kidd
- 10:10 Theme Challenge: Dr. Brian Autry
- 10:20 Special Music: Dr. Leo Day
- 10:30 Introduction of Partner Reports: Dr. Mark Becton
- 10:31 SBCV Partner Reports
The Baptist Banner
LifeWay Christian Resources
Guidestone Financial Resource
Ethics and Religious Liberty
- 10:45 State Ministry Report 2: *Mobilizing Churches*: Mr. Mark Gauthier
- 10:55 Introduction of SBCV Partner Reports: Dr. Mark Becton
International Mission Board
North American Mission Board
SBC Executive Committee
- 11:05 Theme Focus Video
- 11:10 Praise & Worship: Convention Praise Team

- 11:18 Intro and Prayer: Rev. Larry Black
- 11:20 Message: Dr. Bobby Welch
- 11:50 Time of Reflection: Convention Praise Team
- 11:55 Announcements: Mr. Mark Gauthier
- 11:58 Benediction: Rev. Pat Fiordelise
- 12:00 Missions Fair Lunch
Church Planting Luncheon

Tuesday Afternoon

- 1:30 Praise & Worship: Convention Praise Team
- 1:40 Special Music: LU Praise
- 1:50 Welcome: Secretary, Rev. Gordon Ellsworth
Prayer: Rev. Roger Cook
- 1:55 Special Recognition: *The Nehemiah Awards for Service*:
Dr. Doyle Chauncey
- 2:00 Business Session
Unfinished Business
Election of Officers



Bobby Welch

Dr. Bobby Welch serves as Strategist for Global Evangelical Relations for the Southern Baptist Convention. He travels North America and the globe for the sake of strengthening existing relationships and starting new relationships with likeminded evangelicals for the sake of Empowering Kingdom Growth. Prior to this position, he was president of the Southern Baptist Convention; pastored First Baptist Church, Daytona Beach, Florida for 32 years; and continues to be the Originator of the F.A.I.T.H. Evangelism/Discipleship Strategy.

- 2:15 Praise & Worship: Convention Praise Team
- 2:23 Intro and Prayer: Rev. Gary Horton
- 2:25 Theme Challenge: Rev. Wendell Horton
- 2:35 Special Music: LU Praise
- 2:45 State Ministry Report 3: *Multiplying Churches*: Rev. Mark Custalow
- 2:55 Special Recognition: Eagle Awards for Church Planting
- 3:05 Praise & Worship: Convention Praise Team
- 3:10 Intro and Prayer: Rev. Randy Aldridge
- 3:13 Special Music: LU Praise
- 3:20 Message: Rev. Vance Pitman
- 3:55 Time of Reflection: Convention Praise Team
- 4:00 Appreciation and Thanks to Outgoing Officers: Dr. Jeff Ginn
- 4:05 Introduction of 2011 Officers: Dr. Mark Becton
- 4:10 Announcements
- 4:25 Benediction: Rev. Billy Gwinn
- 4:30 Postlude: Convention Praise Team



Vance Pitman

Rev. Vance Pitman is senior pastor of Hope Baptist Church in Las Vegas, Nevada, a church plant of The First Baptist Church of Woodstock, Georgia. He holds a Master's Degree in Divinity from Mid-America Baptist Theological Seminary. Vance speaks all over the nation to stimulate awareness that the Gospel is very needed in our own country as well as all over the world. His expositional teachings and command of the diverse biblical vernacular captivate his audience to where the question is raised of how can I be more involved in the Kingdom?

Program Personalities

ALPHABETICAL ORDER

Rev. Randy Aldridge

SBCV Church Planting Strategist, Southwest Region

Rev. Henry Amedeker

Senior Pastor, Seed International, Richmond, VA

Rev. David Andersen

State Director of Virginia Capitol Commission

Dr. Brian Autry

Senior Pastor, Parkway Baptist Church, Moseley, VA

Dr. Mark Becton

Senior Pastor, Grove Avenue Baptist Church, Richmond, VA, and President of the SBCV

Rev. Charles Billingsley

Worship Leader, Thomas Road Baptist Church, Lynchburg, VA

Rev. Larry Black

SBCV Church Planting Strategist, Central-West Region

Rev. David Bounds

Interim Church Health Strategist, Southeast Region

Rev. Steve Bradshaw

SBCV Director of Maturing Churches and Church Health Strategist, Central-East Region

Dr. Kelly Burris

Senior Pastor, Kempsville Baptist Church, Virginia Beach, VA and Chairman of the SBCV Nominating Committee

Rev. Danny Campbell

Senior Pastor, Wayne Hills Baptist Church, Waynesboro, VA

Dr. Doyle Chauncey

President of the SBCV Foundation and Church Ministry Services and SBCV
Assistant Treasurer

Rev. Roger Cook

Senior Pastor, Crosspointe Community Fellowship, Bluefield, VA

Rev. Jeff Crook

Senior Pastor, Blackshear Place Baptist Church, Flowery Branch, GA

Rev. Mark Custalow

SBCV Director of Multiplying Churches and Church Planting Strategist
Southeast Region

Rev. David Dalton

Minister of Music, Hyland Heights Baptist Church, Rustburg, VA

Rev. Paul Davis, Jr.

Senior Pastor, First Baptist Church, St. Charles, VA and Chairman of the SBCV
Resolutions Committee

Dr. Leo Day

Minister of Music, Olive Baptist Church, Pensacola, FL

Rev. Gordon Ellsworth

Senior Pastor, Virginia Beach Beacon Baptist Church, VA Beach, VA, and Secretary of
SBCV Executive Board

Rev. Pat Fiordelise

Senior Pastor, Kingsland Baptist Church, Richmond, VA

Mr. Mark Gauthier

SBCV Director of Mobilization

Rev. Chris Gill

Senior Pastor, Reservoir Community Church, Yorktown, VA

Dr. Jeff Ginn

SBCV Executive Director–Treasurer

Dr. J. D. Greear

Senior Pastor, The Summit Church, Durham, NC

Rev. Randy Green

Senior Pastor, Harvest Fellowship, Smithfield, VA and 1st Vice President
SBCV Executive Board

Rev. Billy Gwinn

Senior Pastor, Sugar Grove Baptist Church, Sugar Grove, VA

Rev. Neal Hawks

Senior Pastor, Pioneer Baptist Church, Max Meadows, VA and 2nd Vice President of
the SBCV Executive Board

Rev. Brandon Hembree

Minister of Students, Emmanuel Baptist Church, Manassas, VA

Rev. Reggie Hester, III

Senior Pastor, Bethel Baptist Church of Chesapeake, Inc., Chesapeake, VA

Rev. Gary Horton

SBCV Church Health Strategist, Southwest Region

Rev. Wendell Horton

Senior Pastor, Skyview Missionary Church, Fancy Gap, VA

Rev. Nashaat Ibrahim

North American Mission Board Missionary

Rev. Ron Kidd

SBCV Church Planting Strategist, Central-East Region

Rev. John Koch

Senior Pastor, Three Rivers Community Church, West Point, VA

LU Praise, Liberty University

Lynchburg, VA

LU Center for Worship Choir

Lynchburg, VA

Rev. Jack Noble

SBCV Church Health Strategist, Central-West Region

Rev. Carlos Payan

Senior Pastor, Iglesia De Las Americas, Lynchburg, VA

Rev. Brandon Pickett

SBCV Director of Media Services

Dr. Tim Piland

Senior Pastor, Nansemond River Baptist Church, Suffolk, VA

Rev. Vance Pitman

Senior Pastor, Hope Baptist Church, Las Vegas, NV

Rev. Paul Randlett

Contemporary Worship Leader, Hyland Heights Baptist Church, Rustburg, VA

Rev. Robert Rowland

Senior Pastor, Smyrna Baptist Church, Dinwiddie, VA., and Chairman of Maturing Churches Committee of SBCV Executive Board

Dr. Bryan Smith

Senior Pastor, First Baptist Church, Roanoke, VA

Rev. Banks Swanson

Senior Pastor, Shenandoah Community Fellowship, Woodstock, VA

Rev. Jonge Tate

Senior Pastor, Bedrock Community Church, Bedford, VA

Dr. Ed Taylor

Senior Pastor, Amissville Baptist Church, Amissville, VA

Rev. Darrell Webb

SBCV Church Health Strategist, North Region

Rev. Carl Weiser

Senior Pastor, Hyland Heights Baptist Church, Rustburg, VA, and Chairman of the SBCV Executive Board and Chairman of the Vision 20/20 Team

Dr. Bobby Welch

Strategist for Global Evangelical Relations for the Southern Baptist Convention, Nashville, TN

Rev. Bill Wennersten

SBCV Church Planting Strategist, North Region

Breakout Seminars

The Power of One — Multipurpose Center

Joe Crider, Bryan Smith

The Power of One is a campaign focused on one goal – unity in the church. Transitioning from multiple services with different styles, one unified hour of worship takes coordination and planning across all ages and stages of life. In this forum, you will hear how First Baptist Roanoke, combined their worship hours into a more unified church family, while being revitalized in reaching, winning, baptizing, and adding others to its membership.

Who Rules the Church? – A Calm Look at a Hot Topic — Sanctuary

Ken Keathley

Are Baptist churches doomed to conflict by their very structure? The pastor-led/congregational-rule paradigm seems to invite trouble. This session will survey some of the current models that attempt to maintain the biblical balance while achieving effective leadership.

Revitalizing Your Church — Tent

Richard Harrell, Dennis Hollandsworth, Brent Vickery

What are the indicators that your church needs revitalization? What does a revitalized church look like? What are some necessary steps to church

revitalization? These questions will be addressed in a panel discussion format by three SBCV pastors who have “been there and done that.” You will be encouraged by the testimonies of what God has done in and through His churches.

The Other Side — Room EH 1

Leo Day

There are so many things to go into a dynamic, Biblical music ministry. But not all of those things have to deal with chord charts, praise teams and worship music. You will glean so much from Dr. Leo Day as he brings his experience, education and passion to, “The Other Side of Music Ministry.”

Acts 1:8 Network – Reaching to the Ends of the Earth Together — Room EH 2

Jim & Susan Austin, Jack & Nancy Dunford

The Acts 1:8 Network will be explained and a discussion on how SBCV churches can network together in various missions efforts from Jerusalem, Judea and Samaria to the ends of the Earth. Ample time will be allocated for a question / answer period. Pray, Give, Do and Go!

Breakout Seminars

Introducing...Route 66! — Redemption's Royal Roadway! — Choir Room

Harold Wilmington

A pointed, practical, and tested game plan (with the necessary notes and videos) to effectively overview each of the sixty-six biblical books during 48 information-packed Sunday nights. This concept is known as the SNBC (the Sunday Night Bible Center), a program especially prepared to be taught in your own local church. Actually, this could be used during any given hour per week.

The Church Unleashed — Room D102

Craig Clayton, Kevin Cummings, Jonge Tate, Carl Weiser

Come and learn from a panel of pastors and mission leaders how they mobilized their churches to intentionally engage their communities with the gospel through service projects. They will describe practical steps taken that can be easily reproduced along with some of the results they have realized.

Heart Language Worship – Fiesta de Alabanza — Iglesia de Las Americas, 3630 Old Forest Road, Lynchburg

Javier Benitez

Bienvenidos a un tiempo de celebración y desafío. Tendremos música, enseñanza, y compañerismo en el Señor, todo realizado en español. Será un tiempo de fortalecer los lazos entre los hermanos y hermanas hispanos.

Welcome to a time of celebration and challenge! There will be music, teaching, and fellowship in the Lord. It will all be conducted in Spanish. It will be a time to strengthen the ties that exist between our Hispanic brothers and sisters.

Hispanic Translation Information

Annual Homecoming

Traducción al español estará disponible durante las sesiones plenarias. Las máquinas de traducción pueden ser recogidas en la mesa de registro.

Public services will be translated into Spanish. Translation equipment can be found at the registration table.

Annual Homecoming Events

Registration – Welcome Center

Main Sessions – Sanctuary

Exhibits –Adult Bible Fellowship

LifeWay Store – Lower Lobby

Session 1 — Sunday Evening

Southern Baptist Convention Q&A with Dr. Jeff Ginn (8:45 PM) – Sanctuary

Session 2 — Monday Morning

Breakout Seminars

- The Power of One — Multipurpose Center
- Who Rules the Church? A Calm Look at a Hot Topic — Sanctuary
- Revitalizing Your Church — Tent
- The Other Side — Room EH 1
- Acts 1:8 Network: Reaching to the Ends of the Earth Together — Room EH 2
- Introducing Route 66! Redemption's Royal Roadway — Choir Room
- The Church Unleashed — Room D 102
- Heart Language Worship – Fiesta de Alabanza — Iglesia de Las Americas, 3630 Old Forest Road, Lynchburg

Seminary Luncheons (11:45 AM) — off-site

Visit seminary booths for details.

Session 3 — Monday Afternoon

Affinity Dinners (tickets required, 4:30 PM)

Women's Ministry with guest speaker Cheryl McGuinness (\$12).....	Multipurpose Center
God's Plan for Sharing (\$10)	Tent
Minister of Education (\$10)	Tent
Minister of Music, Worship, & Media (\$10)	Tent
Missions Leaders (\$10)	Tent
Preschool and Children's Ministry (\$10)	Tent
Studentz Ministry (\$10)	Tent

Session 5 — Tuesday Morning

Fellowship Luncheon provided by Disaster Relief ministry for all messengers and guests (\$7; tickets required; 12:00 Noon) – Multipurpose Center

Church Planting Luncheon (by invitation only; 12:00 Noon) – Tent

Hyland Heights — Facilities

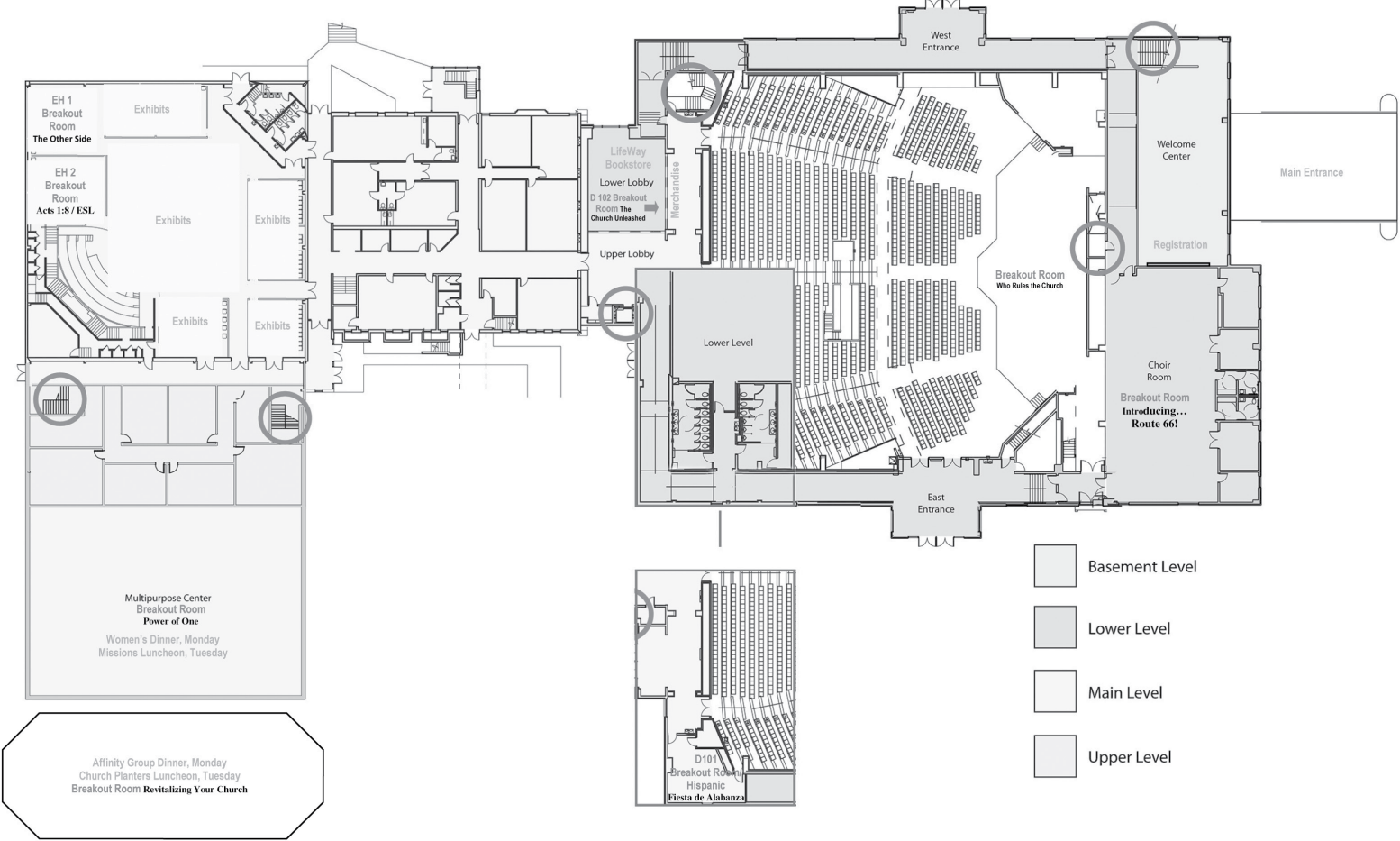

Newly Approved SBCV RESOURCE PARTNERS in 2010

Barnes Design Group, P. C., Virginia Beach, VA, 757.340.9800, www.bdgchurcharchitects.com

Capitol Commission, Chesterfield, VA, 804.796.9411, www.capitolcom.org

Carousel Signs and Designs, Inc., Rockville, VA, 804.620.3200, www.carousel signs.com

Child Evangelism Fellowship, Williamsburg, VA, 757.871.6382, www.cefonline.com

Crain and Associates, Mechanicsville, VA, 804.746.5805, ecrain1@comcast.net

Evangelism International, Chesapeake, VA, 757.905.2195, www.evangelisminternational.us

International Christian Center for the Deaf, Cloverdale, VA, 540.966.3345, www.iccd.net

Lifetouch, Crozier, VA, 804.385.5026, www.lifetouch.com

Light to Israel Ministries, Marshall, VA, 540.364.1103, www.middleeastministries.org

Men at the Cross, Branson, MO, 417.294.4966, www.menatthecross.org

Noble Warriors, Inc., Midlothian, VA, 804.365.8683, www.noblewarriors.org

Project Launch 13 Baptist College, Concord, NH, 603.219.0730, www.pl13.org

Richmond Center for Christian Study, Richmond, VA, 804.852.5151, www.richmondstudycenter.org

Shepherds Ministries, Union Grove, WI, 262.878.5620, www.shepherdsministries.org

TrueLife.org, Youngsville, NC, 919.426.6347, www.truelife.org

Virginia Christian Alliance, Richmond, VA, 804.651.1700, www.vachristian.org

Word of Life, Midlothian, VA, 804.283.2055, www.wol.org

Exhibits

All exhibits will be located in the Adult Bible Fellowship Hall

SBCV Exhibits:

Acts 1:8 Network*
 Baptist Builders*
 Baptist Global Response
 Church Planting
 Church Planting in D.C.
 Contextualized Leadership Development Centers
 Disaster Relief*
 ESL (English as a Second Language)/ MSC
 (Mission Service Corps)*
 Families on Mission/Campers on Mission*
 GPS (God's Plan for Sharing)/Evangelism*
 Maturing Churches*
 Partnerships*
 Projects*
 Studentz/Collegiate Ministries*
 Studentz Mission Plant*
 SWAT (Staff Wives Affecting Tomorrow)
 Vacation Bible School*
 Women's Ministries

Partners Exhibits:

Ethics and Religious Liberties
 Commission
 GuideStone Financial Resources
 International Mission Board
 Liberty Baptist Theological Seminary
 Liberty University
 LifeWay Directory Service
 LifeWay Office Equipment Océ
 LifeWay Ridgecrest Conference Center
 North American Mission Board
 Southeastern Baptist Theological
 Seminary
 Southwestern Baptist Theological
 Seminary
 The Baptist Banner

Resource Partners Exhibits:

Capitol Commission
 Child Evangelism Fellowship
 Evangelism International
 International Christian Centers for the Deaf
 Light to Israel
 Men at the Cross
 Noble Warriors
 Project Launch 13
 Richmond Center for Christian Study
 Shepherd's Ministries
 TrueLife.org
 Virginia Christian Alliance
 Word of Life

*Mobilizing Churches Missions Fair Exhibits:

In your registration packet, you have received a Missions Fair passport. Visit each of the Mobilizing Churches booths in the exhibit hall to have your passport marked. Once you have visited all twelve of the Mobilizing Churches booths, fill in your contact information on the back and drop it off at the Acts 1:8 Network booth. You will be entered to win one of the two mission trip scholarships — \$1,000 for an IMB international trip and \$500 for a NAMB North American trip. The drawing will be held during Session 6 on Tuesday afternoon.

State Missions Team

Jeff Ginn

Executive Director-Treasurer

Doyle Chauncey

President of SBCV Foundation and Church Ministry Services and
SBCV Assistant Treasurer

Mark Gauthier

Director of Mobilizing Churches

Eddie Urbine

Assoc. Church Mobilization Strategist, Partnerships

Randy Aldridge

CPS, Southwest Region

Gary Horton

CHS, Southwest Region

Larry Black

CPS, Central-West Region

Jack Noble

CHS, Central-West Region

Ron Kidd

CPS, Central-East Region

Steve Bradshaw

Director of Maturing Churches and CHS, Central-East Region

Mark Custalow

Director of Multiplying Churches and CPS, Southeast Region

David Bounds

Interim CHS, Southeast Region

Darrell Webb

CHS, North Region

Bill Wennersten

CPS, North Region

Joe Hernandez

Church Planting Consultant, North Region

Steve Maltempi

Student Ministry Strategist

Sue Sawyer

Women's Ministry Strategist and Assoc. Church Mobilization Strategist, Projects

Brandon Pickett

Director of Media Services

CHS — Church Health Strategist

CPS — Church Planting Strategist

2010 Executive Board

SOUTHERN BAPTIST CONSERVATIVES OF VIRGINIA

Convention Officers

Chairman	Rev. Carl Weiser Hyland Heights Baptist Church, Rustburg
President	Dr. Mark Becton Grove Avenue Baptist Church, Richmond
1st Vice President	Rev. Randy Green Harvest Fellowship Church, Smithfield
2nd Vice President	Rev. Neal Hawks Pioneer Church, Max Meadows
Secretary	Rev. Gordon Ellsworth Virginia Beach Beacon Baptist Church, Virginia Beach
Executive Director-Treasurer (SBCV)	Dr. Jeff Ginn
President of the SBCV Foundation and Church Ministry Services (SBCV)	Dr. Doyle Chauncey

L — Layperson

Central-East (6)

Rev. Donald Joyner, Matoaca Baptist Church, Matoaca
Dr. Randy Hahn, Colonial Heights Baptist Church, Colonial Heights
Rev. Roger McNiel, Swift Creek Baptist Church, Midlothian
Rev. Robert Rowland, Smyrna Baptist Church, Dinwiddie
Mrs. Amy Stewart, Beaverdam Baptist Church, Beaverdam (L)
Mr. Tony Sendaydiego, Parkway Baptist Church, Moseley (L)

Central-West (9)

Rev. Rick Ewing, Pleasant View Baptist Church, Lynchburg
Rev. Carl Weiser, Hyland Heights Baptist Church, Rustburg
Rev. Joey Bray, The Tabernacle, Danville
Rev. Greg Moser, Green Ridge Baptist Church, Roanoke
Mrs. Teresa Sours, Wayne Hills Baptist Church, Waynesboro (L)
Rev. Doug Ramsey, Hillcrest Baptist Church, Ridgeway
Mr. Wayne Sink, Preston Oaks Baptist Church, Roanoke (L)
Mr. Jim Looney, Craig Valley Baptist Church, New Castle (L)

North (4)

Dr. Ed Taylor, Amissville Baptist Church, Amissville
Rev. Jim Stone, Spotswood Baptist Church, Fredericksburg
Rev. Bill Hatcher, Centreville Baptist Church, Centreville
Rev. Eliezer Perez, Iglesia Bautista Hispana Emanuel, Manassas

Southeast (8)

Rev. Jonathan Carpenter, Exmore Baptist Church, Exmore
Rev. Randy Green, Harvest Fellowship Baptist Church, Smithfield
Mr. Arthur Leary, Liberty Baptist Church, Hampton (L)
Rev. Curt Breland, First Baptist Church, Norfolk
Rev. Stewart McCarter, Southside Baptist Church, Suffolk
Mrs. Sharon Piland, Nansemond River Baptist Church, Suffolk (L)
Rev. Dennis Hollandsworth, Seaford Baptist Church, Seaford
Rev. Gordon Ellsworth, Va. Beach Beacon Baptist Church, Va. Beach

Southwest (3)

Rev. Neal Hawks, Pioneer Baptist Church, Max Meadows
Rev. Wendell Horton, Sky View Missionary Baptist Church, Fancy Gap
Rev. Lonnie Brooks, East Stone Gap Baptist Church, East Stone Gap

Minutes of the 2009 Annual Homecoming

Pushing Back the Darkness through Evangelism: Every Believer Sharing, Every Person Hearing *First Baptist Church, Norfolk, VA* *November 8-10, 2009*

SUNDAY EVENING SESSION, NOVEMBER 8, 2009

Theme: Every Believer Sharing, Every Person Hearing

Rev. Jeff Brocaille, minister of music at First Baptist Church of Norfolk, welcomed those in attendance. The First Baptist praise team and choir led the congregation in worship with the songs, "Our God Saves," "Mighty to Save," and "Amazing Grace (My Chains Are Gone)." Brocaille then led the choir in singing, "Let the Church Rise."

SBCV President Dr. Tim Hight welcomed the messengers and guests and thanked them for making the trip to Norfolk and rearranging their Sunday schedules to accommodate the new Annual Homecoming schedule.

Executive Director Dr. Jeff Ginn made an announcement in Spanish for the Hispanic brothers and sisters about translation equipment being available for those who need it.

Hight thanked First Baptist and Dr. Eric Thomas, senior pastor, for hosting the Annual Homecoming. Rev. Phillip Herring, minister of education at First Baptist, spoke on behalf of Thomas, whose grandmother passed away, inhibiting him from attending. Herring gave an opening prayer.

Dr. Don Cockes, church health strategist for the Southeast Region, introduced Dr. Seong Soo Kim, who would be presenting the overall theme challenge:

"every believer sharing, every person hearing." Cockes also introduced special musical guests, the Nelons. The Nelons then sang, "I Bless Your Name" and "Love You with My Life." Dr. Kim shared from Isaiah 54 and exhorted Christians to reach America for Christ and give more to missions. Without missionaries, his family would not have come to Christ in Korea. Christians should not be satisfied with keeping their resources for themselves.

The First Baptist choir sang, "The Majesty and Glory of Your Name." They also led the congregation in singing, "Hallelujah to the Lamb."

Rev. Gary Horton, church health strategist for the Southwest Region, introduced and prayed for Dr. Daniel Akin, the keynote speaker for the evening. The Nelons then shared the song, "Lamb of God." Dr. Akin gave a convicting sermon entitled, "A Great Commission Advance," which was based in Romans 15. Akin encouraged Southern Baptists to rethink "business as usual" in order to reach a lost and dying world.

Brocaille led the invitation song, "Here I Am." President Hight gave some closing announcements and introduced Rev. Randy Aldridge, church planting strategist for the Southwest Region, who gave the closing prayer.

A Great Commission Resurgence question and answer time with Dr. Akin followed in the chapel.

MONDAY MORNING SESSION, NOVEMBER 9, 2009

Rev. Paul Randlett, contemporary worship leader at Hyland Heights Baptist Church in Lynchburg, and the Convention Praise Team led in worship with the songs, “Holy Is the Lord,” “How Great Thou Art,” and “How Great Is Our God.” President Tim Hight welcomed guests and messengers and introduced the Convention Praise Team and Paul Randlett. Hight then welcomed Dr. Kelly Burris, senior pastor of Kempsville Baptist Church in Virginia Beach, who opened the session in prayer.

Executive Director Jeff Ginn recognized Thomas Road Baptist Church in Lynchburg as the winner of the Pentecost Award for the church with the highest number of baptisms. Dr. David Randlett, senior associate pastor for Thomas Road, accepted the award on behalf of Rev. Jonathan Falwell, senior pastor, who could not be present.

Rev. Steve Bradshaw, director of Maturing Churches and church health strategist for the Central-East Region, read the list of upcoming breakout sessions. Bradshaw introduced Rev. Eric Farel, senior pastor of Shenandoah Heights Baptist Church in Stephens City, who closed the session in prayer. Farel also asked for prayer for his 28-year-old son John with cystic fibrosis, awaiting a lung transplant at UVA.

Two consecutive breakout sessions followed from 9:15 to 10:15 AM and 10:30 to 11:30 AM. Topics included, “Evangelism for the 21st Century” (led by Dr. Gray Allison), “Every Church an Acts 1:8 Church” (led by Rev. Jerry Daniel, Mr. Chip Hewette, Rev. Craig Clayton, and Rev. Neal Hawks), “Exploring Multi-site Churches” (led by Rev. Jimmie Davidson and representatives from Thomas Road Baptist Church), “Revitalizing Your Church” (led by Rev. Rusty Small, Rev. Stewart McCarter, and Rev. Greg Pulling), “Who Runs the Church: a Calm Look at a Hot Topic” (led by Dr. Ken Keathley), and “Fiesta de Alabanza” (led by Dr. David Lema Jr.).

Seminary lunches followed the breakout sessions at off-site locations.

MONDAY AFTERNOON SESSION, NOVEMBER 9, 2009

Theme: Every Believer Sharing, Every Person Hearing

Paul Randlett introduced Lorenzo Jackson, guest musician. Jackson shared a concert of special music.

An SBCV 360 video was shown highlighting SBCV events since the last Annual Homecoming.

President Tim Hight welcomed the messengers and guests and introduced Rev. Mike Cauthorne, senior pastor of CenterPoint Church in Mechanicsville, who gave the opening prayer.

Paul Randlett and the Convention Praise Team led in worship with the songs, “Mighty to Save” and “God of This City.”

President Hight introduced Rev. Gary Sanders, minister of military ministries at First Baptist Church of Norfolk, who led the Pledge of Allegiance. Rev. Brandon Pickett, director of Media Services, read a statement memorializing the military men and women who were killed in the previous week’s shooting in Fort Hood, TX. Rev. David Andersen of Capitol Commission prayed for America, its leaders, and its pastors. Hight introduced Major General Robert Newman Jr., who thanked the SBCV for its participation in projects to support America’s troops.

The Nelons thanked our troops for their service and sang, “The Star-Spangled Banner.” Kelly Nelon Clark introduced the members of the Nelons. The group then sang, “We Speak Your Name.”

Brandon Pickett introduced a video about God’s Plan for Sharing (GPS), a joint evangelism effort between churches, state conventions, and the North

American Mission Board. The promotional video for GPS was then shown. Pickett introduced another video about a church in Ontario, CA, who used GPS to reach its community for Christ through a pilot program with the Inland Empire Baptist Association.

President Hight recognized Rev. Jason Barber, chairman of the Resolutions Committee and senior pastor of North Main Baptist Church in Danville. Barber shared that messengers who would like to submit resolutions should turn them in to the minutes table by the close of that session. Hight announced that there were 581 messengers and 251 guests, for a total of 832.

President Hight recognized the SBCV officers and the parliamentarian and asked them to stand (Executive Director Jeff Ginn, Executive Board Chairman Carl Weiser, 1st Vice President Michael Palmer, 2nd Vice President Brian Autry, Secretary Michael C. Smith, and Parliamentarian Gene Primm). Hight directed messengers to the 2008 minutes on pages 8-21 of the Book of Reports and said they would stand approved if there were no questions, of which there were none. He then said the program on pages 2-4 of the Book of Reports would stand approved since there were no changes to be made. Hight asked messengers to keep comments to three minutes or less. Hight then read the names of the Order of Business Committee (Executive Board Chairman Carl Weiser, President Tim Hight, 1st Vice President Michael Palmer, 2nd Vice President Brian Autry, and Assistant Treasurer Doyle Chauncey).

Hight introduced Executive Director Jeff Ginn to give the Executive Director's Report. Ginn shared his report, beginning on page 22 of the Book of Reports. Ginn recognized Matoaca Baptist Church in Matoaca, recipient of the Macedonia Award for the church with the highest Cooperative Program giving per capita. Rev. Donald Joyner, senior pastor of Matoaca, accepted the award. Ginn then recognized Liberty Baptist Church in Hampton, recipient of the Macedonia Award for the church with the highest Cooperative Program giving. Dr. Grant Ethridge, senior pastor of Liberty, accepted the award.

Hight then recognized Rev. Carl Weiser, senior pastor of Hyland Heights Baptist Church in Lynchburg and chairman of the Vision 20/20 Team. Weiser presented the Vision 20/20 Report, found on pages 55-57 in the Book of Reports. The six major emphases of the report were that the SBCV be:

1. **A multiplying missional network** ... in which the number of congregations grows from over 500 to over 1,000, including the planting of 400 new congregations.

Church planting has been the heartbeat of the SBCV since its inception. The recommendation is that we hold to that priority with an even greater zeal. The V20/20 survey indicated that SBCV respondents strongly held that Virginia and the District of Columbia are both underevangelized and underchurched mission fields. Through the planting of churches, both evangelism and discipleship are accelerated. The SBCV will partner with local congregations to insure that healthy churches plant healthy churches that will plant healthy churches.

2. **A maturing missional network** ... in which at least 500 congregations progress to the next level of congregational health.

Churches may be plotted along a spectrum of congregational health. This ranges from churches that are near dissolution to those that are impacting the world in transformational ways. The SBCV will partner with interested local congregations to facilitate an evaluation, prescription, and implementation of a course of action that will, by God's grace, enable them to reach the next level on the spectrum of congregational health.

3. **A mobilizing missional network** ... in which the number of congregations committed to the Acts 1:8 Challenge grows from approximately 50 to over 500.

Churches do not exist merely for the benefit of the local membership. The

church exists to fulfill the Great Commission. The SBCV will partner with local congregations to facilitate missional impact in their Jerusalem, Judea, Samaria, and to the ends of earth.

4. A sacrificial missional network ... in which ever greater resources are channeled to national and international mission causes through the Cooperative Program (CP).

The SBCV will partner with national entities to fulfill the Great Commission. The SBCV already sets a national standard by forwarding a full 50% of its CP receipts to the SBC. The V20/20 Team recommends that this be increased by a quarter of a percent each year for the next 10 years, subject to an annual review. This is based on the conviction that God's Word is true: "Give, and it will be given to you. A good measure, pressed down, shaken together and running over, will be poured into your lap. For with the measure you use, it will be measured to you" (Luke 6:38). Early estimates are that this will mean an additional 1.2 million dollars for national and international mission causes over the next decade.

The missional needs within the Commonwealth of Virginia and the District of Columbia are staggering. The case could be made that all mission receipts could be kept within our boundaries and put to good use. There is that much lostness within the geographic boundaries of our convention. Local churches might employ a similar argument for keeping their resources localized. However, a paradox is at work here. As we each sacrifice to reach a lost world, the Lord will entrust more resources to us to reach our Jerusalem and Judea. The V20/20 Team urges that this challenge be taken up by every believer and every constituent church in our convention as the SBCV sets the example.

5. A streamlined missional network ... in which the decentralized model of ministry for which the SBCV is noted nationally will be furthered so that

the state convention becomes even more accessible to the local church.

In its last major restructuring, the SBCV emphasized a decentralized model of state ministry that has proven effective. Other conventions from across the nation have embraced this paradigm. The V20/20 Team recommends an accentuation of the decentralized approach by realigning into five major regions, each of which will have clusters organized around demographic centers.

The streamlining of our convention will also extend to programmatic scheduling. Many of the training events that have historically been offered will be coalesced into a new conference called E412. E412 is an equipping conference that weds together the best elements of many of our conferences, including the Evangelism and Church Leadership Conferences. E412 will be the major spring semester event while the Annual Homecoming will be the major fall semester event.

6. A contextualized missional network ... in which the timeless principles of God's Word are communicated effectively in the ever-changing culture in which we live. Further research into the name and branding of our convention should be undertaken.

Hight recognized Dr. Ed Taylor, chairman of the Relations Committee and senior pastor of Amissville Baptist Church in Amissville, to present the Church Affiliation Report, found on page 58 in the Book of Reports. Taylor asked the messengers to welcome the churches into the convention. Attendees responded with applause. Taylor then read the recommendation: "The Executive Board recommends to the messengers in the 2009 Annual Homecoming that churches requesting affiliation in this year's meeting be enthusiastically received into the SBCV." Hight explained that because the recommendation came from the Executive Board, it did not need a second. He then asked for discussion or questions, of which there were none. He then

called for an “amen” vote, which was unanimous.

Hight asked for questions about the Vision 20/20 Report and requested that the Vision 20/20 Team stand. There were no questions. Hight asked for a vote to adopt the report. A unanimous “amen” vote was taken.

Hight asked pastors and staff who were new to the convention since the last Annual Homecoming to stand. The convention applauded in a spirit of welcome.

President Hight recognized Dr. Doyle Chauncey, assistant treasurer, to present the proposed Ministry Investment Plan (MIP), found on pages 62-65 of the Book of Reports. Chauncey stated that he would be available to receive questions at the end of the evening session and thanked the churches for continuing to give to the Cooperative Program despite the current economic crisis. Chauncey presented the proposed MIP. Significant points were:

1. The \$9.2 million 2010 Ministry Investment Plan represents a 3.16% decrease from the 2009 Ministry Investment Plan, and a 0% increase from projected Cooperative Program contributions for the fiscal year ending December 31, 2009.
2. \$4,623,000 or 50.25% of all undesignated Cooperative Program contributions will be invested monthly in direct missions through the Southern Baptist Convention distributed according to the SBC budget approved annually by church-authorized messengers attending the Annual Southern Baptist Convention.
3. The \$4,577,000 or 49.75% SBCV portion of Cooperative Program contributions, the \$700,000 SBC partner contributions, and the \$600,000 strategic opportunity funds will fund the direct and indirect SBCV Plan (\$5,877,000).

4. The Total SBCV Indirect Ministry Investment (\$2,038,056) is allocated on a percentage basis to the Total SBCV Direct Ministry Investment (\$3,838,944) to report the scope and level of our commitment toward fulfilling the three strategic objectives of the SBCV:

- \$3,095,304 or 52.67% will be invested in multiplying churches located within the five (5) regions of the SBCV.
- \$2,315,572 or 39.40% will be invested in maturing churches within the five (5) regions of the SBCV.
- \$466,124 or 7.93% will be invested in mobilizing churches to be engaged in Acts 1:8 missions and ministries.

5. Fifty and one-quarter of 1% (50.25%) of Cooperative Program funds received in excess of \$9.2 million in 2009 will be forwarded to the Southern Baptist Convention

6. Any unexpended SBCV funds will be carried forward for future church planting and other strategic ministry opportunities.

Chauncey then read the Executive Board’s recommendation: “The Executive Board recommends to messengers in the 2009 Annual Homecoming that the proposed 2010 Cooperative Program Ministry Investment Plan in the amount of \$9,200,000 be adopted.”

Hight reminded messengers that if they had questions after the session, Chauncey would be available at the front of the sanctuary at the close of the evening session. Hight asked if there were any questions at that time. There were none. Hight announced that the vote on the MIP would take place Tuesday morning at the allotted time for business, 9:25 AM.

Hight recognized Rev. Rick Caldwell, chairman of the Nominating Committee and senior pastor of Concord Baptist Church in Farmville, to

present the Nominating Committee Report, found on page 59 of the Book of Reports. Caldwell explained that the convention was only voting on the new members. He then read the recommendation: "The Nominating Committee recommends to messengers in the 2009 Annual Meeting that persons nominated in this year's meeting be approved to serve on the 2010 Executive Board of the SBCV. Note: Term expires at the end of the annual meeting of the year indicated." Hight asked for questions or discussion, of which there were none. He then called for an "amen" vote, which was unanimous.

Paul Randlett and the Convention Praise Team led in worship with the songs, "Let the Praises Ring" and "Christ the Lord Is Risen Today."

Rev. Jack Noble, church health strategist for the Central-West Region, introduced Rev. Jason Barber, senior pastor of North Main Baptist Church in Danville, who would be giving the theme challenge: "every believer" of "every believer sharing, every person hearing." Noble also recognized Rev. Chris Dowd, associate pastor at Bedrock Church in Bedford, who prayed for Barber and the remainder of the session.

Lorenzo Jackson sang, "I Need You."

Barber shared from 2 Timothy 1:7, reminding the convention that fear should not be a factor in sharing the Gospel.

Paul Randlett and the Convention Praise Team led in worship with the songs, "Cover the Earth," and "Our Heart."

Rev. Larry Black, church planting strategist for the Central-West Region, introduced and prayed for Dr. B. Gray Allison, the keynote speaker for the session. Allison shared about the history and mission of Mid-America Baptist Theological Seminary. He then preached from the Book of Jude, verses 20-25, reminding believers of the urgent need to share the Gospel.

Paul Randlett and the Convention Praise Team led the invitation with "Amazing Grace."

Hight and Steve Bradshaw gave closing announcements regarding the schedule for the evening session and the upcoming dinners.

Hight introduced Dr. Wayne Guynn, senior pastor of First Baptist Church in Damascus, who gave the benediction prayer.

The session was followed by affinity group dinners: Women's Ministry, church planting, GPS, ministers of music/worship, ministers of education, and Studentz Ministry.

MONDAY EVENING SESSION, NOVEMBER 9, 2009

Theme: Every Believer Sharing, Every Person Hearing

The session began with a concert by the Nelons.

1st Vice President Dr. Michael Palmer, senior pastor of Green Ridge Baptist Church in Roanoke, thanked the Nelons and introduced the combined choir from Kempsville Baptist Church in Virginia Beach, London Bridge Baptist Church in Virginia Beach, and First Baptist Church of Norfolk. The choir sang, "Jesus Saves" and "Days of Elijah."

A second SBCV 360 video was shown highlighting SBCV events since the last Annual Homecoming.

Palmer thanked Executive Director Ginn and the SBCV staff and announced that there were 643 messengers and 267 guests, for a total of 910. Palmer then introduced Rev. Scott Hesler, senior pastor of Potomac Baptist Church in Potomac Falls, who gave the opening prayer.

Rev. Bill Wennersten, church planting strategist for the North Region, introduced Rev. Daniel Floyd, senior pastor of Lifepoint Church in Fredericksburg, to give the theme challenge: “sharing” of “every believer sharing, every person hearing.” Floyd shared from Luke 15:20 about the Prodigal Son, reminding the convention not to lose the heart of the Father to reach the lost.

Paul Randlett, the Convention Praise Team, and the combined choir led in worship with the songs, “Jesus Paid It All” and “We Will Remember.”

A Multiplying Churches video was shown, which told the story of Reservoir Community Church in Newport News and a woman named Jody who came to Christ through the consistent and persistent witness of the church plant.

Rev. Mark Custalow, director of Multiplying Churches and church planting strategist for the Southeast Region, introduced Rev. Jamie Limato, senior pastor of church plant Aletheia Norfolk. Limato shared about the start of Aletheia Norfolk and how the church is ministering and witnessing to students at Old Dominion University.

Custalow shared about the Multiplying Churches arm of the SBCV and the need for church planting in Virginia and Washington, DC to fulfill the Great Commission. He asked SBCV church planting strategists and associate church planting strategists to stand. Custalow then introduced the Eagle Award video, which highlighted Winn’s Baptist Church in Glen Allen, which helped plant CenterPoint Church in Mechanicsville. Custalow then asked Rev. Mike Cauthorne, senior pastor of CenterPoint, and Rev. Jeff Chadwick, associate pastor at Winn’s, to stand. Since the SBCV’s beginning, a full 33% of its churches have actively engaged in sponsoring a new church. This far surpasses the national average of 6%.

Custalow then introduced Rev. Roger McNiell, chairman of the Church Planting Committee of the Executive Board and minister of music at Swift Creek Baptist Church in Midlothian, and Rev. Daniel Floyd, chairman of the Multiplying Churches subcommittee of the Vision 20/20 Team. McNiell and Floyd read the list of 2009 Eagle Awards for sponsor churches:

Sponsor Church	Church Plant
1. Beulah Baptist, Lynchburg Maurice McCarthy	Movement Church, Richmond Cliff Jordan
2. Colonial Heights Baptist Colonial Heights Randy Hahn	Living Water Church, Anacostia Art Thompson
3. First Baptist, Norfolk Eric Thomas	Mosaic, Hampton Roads Steve Byrum
4. First Baptist, Pound Jerry Lusk	Grace Fellowship, Haysi Jeremiah Sluss
5. Grace Community Baptist Richmond Guy Holloway	Swagath South Asia Richmond, Newport News Anant Shinde
6. Green Ridge Baptist, Roanoke Mike Palmer	Restoration Church, Northwest Washington, DC Nathan Knight
7. Grove Avenue Baptist, Richmond Mark Becton	Village Church of Midlothian Midlothian Steve Gentry
8. Hillcrest Baptist, Ridgeway Douglas Ramsey	Iglesia Bautista De Hillcrest Ridgeway Tim Harville

Sponsor Church	Church Plant
9. Hyland Heights Baptist Lynchburg Carl Weiser	Oasis Church, Lynchburg George Rose
10. Iglesia Bautista El Refugio Richmond Jason Carlisle	Iglesia Bautista Nueva Esperanza Richmond Fernando Mangieri
11. Iglesia Bautista El Camino Richmond Clovis Pause	Iglesia Bautista Nueva Esperanza Richmond Fernando Mangieri
12. Kingsland Baptist, Richmond Pat Fiordelise	Iglesia Bautista Nueva Esperanza Richmond Fernando Mangieri
13. Midway Baptist, Phenix Joey Anthony	Movement Church, Richmond Cliff Jordan
14. Mount Pleasant Baptist Colonial Heights Curtis Barnes	Remnant Church, Richmond Ryan Kidd
15. New Life Community, Louisa Josh Turner	The Point Church, Charlottesville Gabriel Turner
16. Palestine Baptist, Huddleston Jackie Carver	True Course Community, Va. Beach Bert Kirk
17. Parkway Baptist Church Moseley Brian Autry	Fellowship Baptist, Richmond Richard Lee The Quest, Richmond Richie Underhill Village Church, Midlothian Steve Gentry

Sponsor Church	Church Plant
18. Pleasant View Baptist Lynchburg Rick Ewing	The Point Church, Charlottesville Gabriel Turner
19. Reservoir Community Newport News Chris Gill	Swagath South Asia Richmond, Newport News Anant Shinde
20. Rosedale Baptist, Abingdon Don Paxton	Bridge of Hope, Abingdon Danny Thompson Crossroads Community, Abingdon John Stapleton
21. Smyrna Baptist, Dinwiddie Robert Rowland	The Opposite Way, Richmond
22. Staples Mill Road Baptist Glen Allen Jim Booth	Swagath South Asia Richmond, Newport News Anant Shinde
23. Tsena Commocko Providence Forge Tim Chrisman	Three Rivers Community West Point John Koch
24. Upperville Baptist, Upperville Bill Wennersten	Brambleton Bible Fellowship Charlottesville Jason Walker DC Urban New Work Greater Washington, DC Cris Pablo Reformation Alive Temple Hills, MD Eric Redmond

Sponsor Church	Church Plant
25. Victory Baptist, Stafford John Hodgen	Living Water Church, Anacostia Art Thompson
26. Va. Beach Beacon Baptist Va. Beach Gordon Ellsworth	Aletheia—ODU, Norfolk Jamie Limato True Course Community, Va. Beach Bert Kirk

Custalow encouraged the convention to pick up prayer cards at the church planting booth in the exhibit hall and pray for church planters. Jeff Brocaille, the First Baptist praise team, and the combined choir led in worship with the songs, “Be the Center” and “It Is Well.”

Dr. Don Crain, associate church health strategist for the Central-East Region, introduced and prayed for Dr. Tom Elliff, the keynote speaker for the session. Crain also welcomed back Lorenzo Jackson, who sang, “What Held You on the Cross.”

Elliff thanked Dr. Ginn and the SBCV for the opportunity to preach at the Annual Homecoming. He then preached from Psalm 42:1-2. Elliff connected the thirst for God with a passion for evangelism. The existence of thirst is a sign of life; where there is no thirst for God, there is no life. Elliff encouraged attendees to come to the altar in repentance and prayer. Rev. Zack Zbinden, senior pastor of Salem Baptist Church in Crozier, prayed for an increased hunger and thirst for God.

Paul Randlett and the Convention Praise Team led the invitation with the song, “Hear Us from Heaven.”

President Hight invited messengers and guests back to the Tuesday morning session at 9:00 AM the next day and then closed in prayer.

TUESDAY MORNING SESSION, NOVEMBER 10, 2009

Theme: Every Believer Sharing, Every Person Hearing

Paul Randlett introduced the Convention Praise Team members. The team then led in worship with the songs, “Everlasting God” and “Dwelling Place.”

Randlett then introduced Marc Ivey to present special music. Ivey sang, “How Great Is Our God,” and asked the congregation to sing along. He then sang, “Amazing Grace.”

A third 360 video was shown highlighting SBCV events since the last Annual Homecoming.

2nd Vice President Dr. Brian Autry welcomed the convention to the morning session. Autry introduced Dr. Grant Ethridge, senior pastor of Liberty Baptist Church in Hampton, who gave the opening prayer.

President Hight announced that there were 652 messengers and 276 guests, for a total of 928. Hight asked Carl Weiser, chairman of the Executive Board, to come to the platform to read the recommendations from the board. Weiser read the recommendation regarding the proposed Ministry Investment Plan: “The Executive Board recommends to messengers in the 2009 Annual Meeting that the Proposed 2010 Cooperative Program Investment Plan in the amount of \$ 9,200,000 be adopted,” found on page 65 of the Book of Reports. Hight reminded messengers that Dr. Chauncey was available to answer questions the previous evening. He then called for an “amen” vote, which was unanimous.

Hight asked Jason Barber, chairman of the Resolutions Committee to present the committee’s report. Barber then asked the members of the committee to stand. Barber read the first proposed resolution, which was shown on the screens.

RESOLUTION 1

Resolution on appreciation

WHEREAS, the messengers of the Annual Homecoming 2009 of the Southern Baptist Conservatives of Virginia have enjoyed a time of encouragement, worship, unity, and the Spirit's direction; and

WHEREAS, we acknowledge the Lord's providence for all of these blessings and

WHEREAS, we acknowledge the hospitality of the people of Norfolk, Virginia, and

WHEREAS, we acknowledge the Kingdom-focused work of Dr. Eric Thomas and of the people of First Baptist Church of Norfolk, Virginia, who worked diligently to bless us with kindness and service, and

WHEREAS, we acknowledge the extraordinary commitment, extensive labor, and excellent leadership of the Southern Baptist Conservatives of Virginia Executive Director and Treasurer Dr. Jeffery B. Ginn, and

WHEREAS, we also acknowledge the Lord working through our officers, various committees, speakers, musicians, and other platform personnel to guide the affairs of this convention with a Christ-like spirit, professionalism, and common vision.

Therefore, be it **RESOLVED**, that the messengers to the Southern Baptist Conservatives of Virginia meeting in Norfolk, Virginia, November 8-10, 2009, express our profound gratitude to our Lord and Savior Jesus Christ and to those whom He used to bring about a convention characterized by revival, evangelistic passion, worship, encouragement, and unity to the glory of God the Father.

Hight asked for questions, of which there were none. He then called for an "amen" vote, which was unanimous.

Barber then read the second resolution, which was shown on the screens.

RESOLUTION 2

Resolution on prayer for elected officials

WHEREAS, The Southern Baptist Conservatives of Virginia believe in and are committed to the inerrancy, veracity, and infallibility of God's Holy Word, and

WHEREAS, 1 Timothy 2:1-4 instructs believers to pray for those in authority over us, and

WHEREAS, Romans 13:1 proclaims to Christians that there is no governing authority which God has not established, and

WHEREAS, messengers of the Southern Baptist Conservatives of Virginia serve a Sovereign God that is affirmed in Psalm 24:1, where we read, "The earth is the LORD's, and everything in it, the world, and all who live in it."

Therefore, be it **RESOLVED**, that we, the Southern Baptist Conservatives of Virginia, meeting in Norfolk, Virginia, November 8-10, 2009, commit to pray earnestly for our president, cabinet, and all newly elected and existing officials.

Hight asked for questions, of which there were none. He then called for an "amen" vote, which was unanimous.

Barber then read the third resolution, which was shown on the screens.

RESOLUTION 3

Resolution on appreciation for the Armed Services of the United States of America

WHEREAS, in appreciation of Christ's sacrifice on the cross for our sins, we acknowledge the value of the sacrificial service of our Armed Service veterans, and

WHEREAS, through God's sovereign grace, their service has secured and defended the religious freedoms we enjoy, and

WHEREAS, there are many currently serving in harm's way.

Therefore, be it RESOLVED, that we salute all veterans of the United States Armed Services for their commitment and sacrifice in the defense of our Constitution.

Be it further RESOLVED, that we pray for those who suffered in the line of duty and the families that bare the scars of those who paid the ultimate sacrifice.

Be it also RESOLVED, that we pray for the safety of those who remain in active service both at home and abroad.

Hight asked for questions, of which there were none. He then called for an "amen" vote, which was unanimous.

Barber then read the fourth resolution, which was shown on the screens.

RESOLUTION 4

Resolution on prayer for the Great Commission Task Force

WHEREAS, Southern Baptists have always been a Great-Commission people who long to see believers and churches multiply, and

WHEREAS, SBC statistics report that perhaps as many as 70% of Southern Baptist churches are plateaued or declining, and

WHEREAS, we recognize that we as Southern Baptists are looking to "reorder our priorities, refocus our vision, reclaim our mission, and set our hearts on seeing the nations exult in the name of Jesus," and

WHEREAS, in order to address these needs, the Southern Baptist Convention saw fit to commission a Great Commission Task Force to examine and recommend necessary actions "concerning how Southern Baptists can work more faithfully and effectively together in serving Christ through the Great Commission."

Therefore, be it RESOLVED, that we, the messengers of the SBC of Virginia,

commit to pray for the leadership of the Holy Spirit in the lives of the task force members.

Be it further RESOLVED, that we pray for all of us as Southern Baptists to be open to God's leadership in our convention . . . for His glory.

Hight asked for questions, of which there were none. He then called for an "amen" vote, which was unanimous. Barber followed in prayer, asking the Lord to help the convention fulfill the resolutions.

Paul Randlett and the Convention Praise Team led in worship with the songs, "The Power of the Cross" and "Revelation Song."

Rev. Darrell Webb, church health strategist for the North Region, introduced and prayed for Dr. Drew Landry, senior pastor of Spotswood Baptist Church in Fredericksburg, who would share the theme challenge: "every person" of "every believer sharing, every person sharing." Landry shared from John 3:16, reminding the convention that every person needs to hear the Gospel. Landry asked his church staff members to pass out a dollar bill to each person in attendance and explained that the dollar enables each person to give at least one more dollar to the Lottie Moon Christmas Offering for International Missions this year than they have before.

The Nelons shared special music, including "Amazing Grace."

President Hight thanked the Nelons. He then asked T.C. Pinckney, editor, and Rev. Cal Wallace, chairman of the Board of Trustees for The Baptist Banner and senior pastor of Good News Baptist Church in Alexandria, to come to the platform. Wallace shared The Banner board's recommendation to add Jeff White, member of Bethel Baptist Church in Chesapeake, and John Lee, member of Immanuel Baptist Church in Chesapeake, to The Banner board. Hight asked for an "amen" vote, which was unanimous. Pinckney announced that the The Banner Award goes to Sue Evans, who formats the articles for The Baptist Banner.

Hight asked Bob Solomon, manager of the Glen Allen LifeWay Christian Store, to come to the platform. Solomon shared that there are now nine LifeWay Christian Stores in Virginia. LifeWay is a ministry supported by a business. Lost people often come to the stores when they are in need spiritually. LifeWay staff members have been able to lead some to Christ. Hight asked Susan May from GuideStone Financial Resources to come to the platform. She shared that GuideStone is still strong even in uncertain economic times. May encouraged pastors to allow GuideStone to help them plan their finances and retirement.

Hight asked Tom Strode, communications director for the Ethics and Religious Liberties Commission (ERLC), to come to the platform. Strode shared that the ERLC is hard at work to influence policy-makers and encouraged the convention to sign up for email updates on the ERLC website. A video was shown from Dr. Richard Land, president of the ERLC.

A Mobilizing Churches video was shown highlighting Baptist Builders. Mark Gauthier, director of Mobilizing Churches, came to the platform to give the Mobilizing Churches Report. Gauthier asked Jack and Nancy Dunford, state Baptist Builders coordinators, to come to the front. He also asked Bob Williams, Wayne and Carolyn Sink, Eddie Urbine, Charles and Anne Baker, and Tom Hankins to come forward. Williams is the state Disaster Relief coordinator, the Sinks are the western DR coordinators, and Urbine is the eastern DR coordinator. The Bakers work with Families on Mission, and Hankins works with Campers on Mission.

Gauthier shared updates on the ministries of the Mobilizing Churches arm of the SBCV (Disaster Relief, Baptist Builders, Families on Mission, and Campers on Mission). A complete report is found on pages 42-43 of the Book of Reports. Gauthier asked Sue Sawyer, SBCV missions project coordinator and Women's Ministry strategist, to stand. He also asked Rev. Eddie Urbine to stand, who is the SBCV associate for partnerships. Gauthier thanked the SBCV churches for their help in missions efforts.

Hight asked Don Lynch from the International Mission Board (IMB), a missionary to Africa on stateside assignment, to come to the platform. Lynch thanked the churches for giving to missions. A video from Dr. Jerry Rankin, president of the IMB, was shown. Rankin thanked the churches for giving to the Cooperative Program and Lottie Moon. Hight asked Jimmy Kinnaird from the North American Mission Board (NAMB) to come to the platform. A video from NAMB was shown, thanking churches for their gifts to the Cooperative Program and the Annie Armstrong Easter Offering for North American Missions. Kinnaird thanked the churches for their missions involvement and gifts. Hight asked Robert Rodgers from the SBC Executive Committee to come to the platform. Rodgers thanked the three Executive Committee members from the SBCV: Jim Davis, Rodney Autry, and G. Harris Warner Jr. He also thanked the churches for their gifts to the Cooperative Program and reminded them of the spiritual warfare in the world.

Brandon Pickett introduced a GPS commercial, which was shown in Spanish. Pickett encouraged churches to visit the GPS booth to get more information. A video was shown of the GPS pilot program through the Philadelphia Association. While the video was shown, SBCV missionaries passed out sample bags of GPS materials to each attendee. Pickett encouraged everyone to visit the GPS website too.

Paul Randlett and the Convention Praise Team sang, "If We Are the Body," and led in worship with "Take My Life and Let It Be."

Randy Aldridge introduced and prayed for Dr. Tim Hight, SBCV president and senior pastor of Main Street Baptist Church in Christiansburg, who would be giving the keynote sermon. Hight preached from Proverbs 27:23 with a sermon entitled, "Tending Our Flocks: So That All May Hear." Hight reminded attendees that the Great Commission focuses on making disciple-making disciples. He exhorted Christians to live changed lives and pastors to

preach Christ and Him crucified to reach the world for Him.

Rev. Cliff Jordan, senior pastor of church plant Movement Church in Richmond, followed in prayer. Mark Gauthier gave instructions for lunch and reminded attendees to get their missions passports punched in the exhibit hall.

TUESDAY AFTERNOON SESSION, NOVEMBER 10, 2009

Theme: Every Believer Sharing, Every Person Hearing

Paul Randlett and the Convention Praise Team led in worship with the songs, “All Hail the Power” and “Dwelling Place.” Randlett then welcomed the Nelons back to the platform to share special music. The Nelons sang, “Hiding Place,” “The Lord’s Prayer,” and “You Are God.”

Secretary Rev. Michael C. Smith, senior pastor of Norview Baptist Church in Norfolk, welcomed the messengers and guests to the session and thanked them for voting for the resolution to pray for America’s military service personnel. Smith’s son is in the Navy and will be deployed in March. He then introduced Rev. Jimmy Meadows, associate church planting strategist for the Southwest Region, who prayed for the session.

Doyle Chauncey asked Dr. Bob Davis, full-time evangelist with Bob Davis Evangelistic Association, to come to the platform. Chauncey recognized Davis for his leadership and service to the SBCV and presented him with a Nehemiah Award. Davis exhorted the convention to stay faithful to the Word. Chauncey asked Rev. Tommy Taylor, senior pastor of London Bridge Baptist Church in Virginia Beach, to come to the platform. He then recognized him for his leadership and service to the SBCV and presented him with a Nehemiah Award. Taylor thanked Davis and Chauncey for their leadership too. Chauncey gave a word of appreciation to everyone who has contributed to the forming of and the continuation of the SBCV.

President Hight called the meeting to order and asked those planning to nominate officers to come to the platform.

Hight called for nominations for the role of SBCV president. Dr. Bryan Smith, senior pastor of First Baptist Church of Roanoke, nominated Dr. Mark Becton, senior pastor of Grove Ave. Baptist Church in Richmond, for president. He also shared some background information about Becton and Grove Ave. Hight asked if there were any other nominations, of which there were none. A second was made from the floor. Hight called for an “amen” vote, which was unanimous.

Hight called for nominations for the role of 1st vice president. Rev. Tim Piland, senior pastor of Nansemond River Baptist Church in Suffolk, nominated Rev. Randy Green, senior pastor of Harvest Fellowship Baptist Church in Smithfield, for 1st vice president. He also shared some background information about Green and Harvest Fellowship. Hight asked if there were any other nominations, of which there were none. A second was made from the floor. Hight called for an “amen” vote, which was unanimous.

Hight called for nominations for the role of 2nd vice president. Dr. Don Paxton, senior pastor of Rosedale Baptist Church in Abingdon, nominated Rev. Neal Hawks, senior pastor of Pioneer Baptist Church in Max Meadows, for 2nd vice president. He also shared some background information about Hawks and Pioneer. Hight asked if there were any other nominations, of which there were none. A second was made from the floor. Hight called for an “amen” vote, which was unanimous.

Hight called for nominations for the role of secretary. Rev. Bert Kirk, senior pastor of True Course Community Church in Virginia Beach, nominated Rev. Gordon Ellsworth, senior pastor of Virginia Beach Beacon Baptist Church, for secretary. He also shared some background information about Ellsworth

and Virginia Beach Beacon. Hight asked if there were any other nominations, of which there were none. A second was made from the floor. Hight called for an “amen” vote, which was unanimous.

Paul Randlett and the Convention Praise Team led in worship with the song, “Holy Is the Lord.”

Rev. Ron Kidd, church planting strategist for the Central-East Region, introduced and prayed for Dr. Jim Booth, senior pastor of Staples Mill Rd. Baptist Church in Glen Allen, who would give the theme challenge: “hearing” of “every believer sharing, every person hearing.” Booth shared from 1 Corinthians 9:19-23 and reminded believers to be all things to all people to make sure they hear the Gospel.

Marc Ivey shared special music with the songs, “Blessed Assurance” and “It’s Still the Cross.” He also sang “Nothing but the Blood of Jesus” and asked the congregation to join him.

Executive Director Jeff Ginn announced Monumental Baptist Church in Petersburg as the winner of the Pentecost Award for the church with the most baptisms per capita. Rev. Barry Ginn, senior pastor of Monumental, accepted the award.

Steve Bradshaw came to the platform to highlight portions of the Maturing Churches Report, found on pages 25-33 in the Book of Reports. Bradshaw recognized the SBCV church health strategists (CHS’s) and associate church health strategists (ACHS’s) per region. He recognized Sue Sawyer, Women’s Ministry strategist; Rev. Steve Maltempi, Studentz Ministry strategist; and Beth Simpson and Emily Handy, support staff members for Maturing Churches. Bradshaw outlined the events, opportunities, and ministries the Maturing Churches arm of the SBCV provides.

Bradshaw emphasized that CHS’s and ACHS’s are available to help churches determine their health. CHS’s and ACHS’s stood, wearing lab coats. Bradshaw then told the stories of churches that have been through different levels of church health:

Restart: Grace Fellowship in Wise

Revitalization: Liberty Baptist Church in Appomattox

Transformation: A Maturing Churches video was shown highlighting Pinecrest Baptist Church in Portsmouth, a church at the transformation stage of church health.

Pregnant: Swift Creek Baptist Church in Midlothian (giving birth to new church plants)

Cross-training: Rosedale Baptist Church in Abingdon (sending out missionaries and new pastors)

Bradshaw then read the definition of a maturing church: “one that is in process of advancing to the next level of health by growing upward and moving outward.” He then encouraged all churches to continue to grow in church health to move upward and outward.

Paul Randlett and the Convention Praise Team led in worship with the songs, “Come Thou Fount, Come Thou King,” and “Sing to the King.” Rev. Steve Swisher, associate church planting strategist for the Southeast Region, introduced and prayed for Dr. Jay Dennis, keynote speaker for the session.

The Nelons provided special music and asked Marc Ivey to join them for a song.

Dr. Jay Dennis shared a message entitled, “Satan’s Favorite Ways to Hide the

Gospel,” based on 2 Corinthians 4:4. Dennis reminded believers of the urgent need to share the Gospel.

Paul Randlett and the Convention Praise Team led the invitation song, “Here I Am.”

Executive Director Jeff Ginn asked the current officers to come to the platform. He then presented them each with a certificate of appreciation.

President Hight thanked Dr. Ginn and the convention for the opportunity he had to serve as president. Hight then asked the newly elected officers to come to the platform:

President Dr. Mark Becton, senior pastor of Grove Ave. Baptist Church in Richmond

1st Vice President Rev. Randy Green, senior pastor of Harvest Fellowship Baptist Church in Smithfield

2nd Vice President Rev. Neal Hawks, senior pastor of Pioneer Baptist Church in Max Meadows

Secretary Rev. Gordon Ellsworth, senior pastor of Virginia Beach Beacon Baptist Church

Rev. Clint Clifton, senior pastor of Pillar Church in Stafford, prayed for the former officers and the new officers.

Dr. Mark Becton, the new SBCV president, thanked the SBCV staff for their hard work in preparing for the Annual Homecoming. Becton announced that the next Annual Homecoming would take place Nov. 7-9, 2010 at Hyland Heights Baptist Church in Lynchburg and that E412 would take place April 29-May 1, 2010 at Swift Creek Baptist Church in Midlothian.

Mark Gauthier came to the platform to announce the winners of the mission trip scholarships. Ginn drew the passports from the box of entries. Milly Wilson from Monumental Baptist Church in Petersburg won the \$500 scholarship for a North American mission trip. Becky Hypes from Bermuda Baptist Church in Chester won the \$1,000 scholarship for an international mission trip.

Becton asked Dr. Philip Parker, senior pastor of Calvary Baptist Church in Portsmouth, to come to the platform. Parker closed the session with a benediction prayer.

Respectfully submitted,

Michael C. Smith
Secretary

Christina S. Garland
Recording Secretary

The Executive Director-Treasurer's Report

SBCV Annual Homecoming, November 7-9, 2010

Dr. Jeff Ginn, Executive Director-Treasurer

God has blessed my wife and me with three wonderful children. I am constantly amazed at how different they are. One is quite disciplined while the others tend to be more carefree. One loves sports; one loves video games; our daughter loved cheering. One saves his money meticulously; the others spend it before it burns a hole in their pockets! One is compliant. Another is strong-willed. The other is a blend of those traits. They are different.

It should be no surprise then that, as parents, we deal with each of them differently. We love them equally but relate to them distinctly according to their particular needs.

I believe that it is fair to say that, in a spiritual sense, the Apostle Paul was a father to many children. His apostolic ministry gave birth, directly or indirectly, to many congregations. The list of them is well known—Rome, Corinth, Galatia, Colossae, etc. His relationship with each was distinct and tailored to that church. Think of it: both the Romans and the Colossians were basically strangers to him. He had not yet been to their fellowships when he wrote them. It seemed as though the Corinthians were always embroiled in one problem or another: cliques, immorality, the abuse of spiritual gifts, and the list continues. The Galatians were threatening to abandon the pure gospel he had proclaimed to them. Each congregation had their particular needs and Paul customized his ministry to address them.

But there was one congregation that rose to the top like cream. Why? It wasn't because of their wealth. They were poor. It wasn't because they were in the most populous or powerful city. It wasn't because he had served there free from persecution or hardship. In fact, the church was born in tumultuous circumstances. Yet his relationship with them was such that he could say with a straight face, "I thank my God every time I remember you" (Philippians 1:3).

I speak of the church at Philippi. What was it about this church that caused him to overflow with gratitude? In short, it was their partnership with him in the gospel. Philippians 1:4-5 says, "In all my prayers for all of you, I always pray with joy because of your partnership in the gospel from the first day until now." Their shared ministry was a cause of unbridled thanksgiving and joy.

What were the objectives of their partnership? The letter gives us clues. In fact, the very next verse drops the first one. Philippians 1:6 affirms that God "who began a good work in you will carry it on to completion." Paul longed, prayed, and labored for their spiritual growth. They were to come to completion. They were to move toward maturity.

Our partnership in the gospel, known as the Southern Baptist Conservatives of Virginia, has this same goal—that He who began a good work in our churches will carry it on to completion. No congregation can remain stagnant and fulfill her role in God's redemptive plan. During our meetings you will hear from our Maturing Churches team exciting stories of churches that are moving toward greater spiritual maturity. The Vision 20/20 task force will reiterate the challenge that five hundred of our churches take the next step in congregational health by the year 2020. You will learn of ways that we can assist you and your church in taking the next step.

A second objective of their partnership was the multiplication of believers and churches. Paul's unwavering goal, even while imprisoned was to "advance the gospel" (Philippians 1:12). The Philippians partnered in this pursuit via their prayers for him, their offerings, and their ministry.

Our SBCV network has this same objective. The Multiplying Churches team is spearheading the planting of more than 400 churches by the year 2020. Each of our congregations can "advance the gospel" as we pray, give, and engage in pursuit of this goal. Throughout our meeting you will hear how our partnership is bearing fruit through the work of new church plants. You will also learn about new initiatives that will expand our church planting capacity.

Finally, it is likely that Paul's encouragement of the Philippians had a further aim; namely, the continued mobilization of that congregation for further missionary efforts. He said, "Not that I am looking for a gift, but I am looking for what may be credited to your account" (Philippians 4:17). He knew that their participation in this gospel partnership would result in their own joy and blessing. There was more yet to do.

I am grateful to report that we have seen an increase this year of more than 50% in the number of churches engaging in the Acts 1:8 Network. This is a great first step toward the Vision 20/20 goal of having five hundred churches committed to an Acts 1:8 strategy in their local fellowship. The Mobilizing Churches team is aggressively developing new partnerships and projects so that every church and every believer can find their place in the Great Commission.

With a straight face, I can borrow the words of Philippians 1:3 and direct them to you: "I thank my God every time I remember you." The churches of the

SBCV are at the forefront of this kind of Great Commission partnership.

How valuable is our partnership? How important is it that we be numbered among the churches that share "in the matter of giving and receiving" (Philippians 4:15) for missions expansion? It is essential. It is the lifeline of missions in Jerusalem, Judea, Samaria, and the uttermost parts. You can almost hear a tinge of regret when Paul says that "not one church shared . . . except you only." In a day when it seems that there is the threat of an erosion of our partnership on a national level, it is vital that we continue to set an example of generosity and trust.

James L. Sullivan, former SBC president and statesman, once described our cooperative ministry as Southern Baptists as a "rope of sand with strength of steel." The rope of sand is a reference to the fact that our shared ministry is not by compulsion but is totally voluntary. The steel is an allusion to the rock-ribbed commitment we have to this biblical model. What a joy it is to be linked together by this kind of bond!

If any state convention can set the example of increasing cooperative giving and going, we can. Our state network is lean. There is no "bloated bureaucracy" and even the streamlined structure that we have is in the process of being refined further. This past year, even in a down-turned economy, the SBCV sent its highest percentage of CP monies ever to our national partner for Great Commission ministries. For this to continue unabated, I invite each church in our network to take up the challenge of increasing its CP giving.

Many voices have said that the SBCV is a prototype of how a state convention should be structured and function. In a sense the eyes of the nation are upon us. For the glory of God and the good of those who have yet to hear the Good News, may we be found faithful, partnering together for the Gospel.

Treasurer's Report

SBCV Annual Homecoming, November 7-9, 2010

Dr. Jeff Ginn, Executive Director-Treasurer

COOPERATIVE PROGRAM (CP)

For the twelve month period that ended August 31st, the SBCV received \$8.86 million for CP Missions from SBCV-affiliated and other SBCV-supporting churches. This compares to \$9.03 million during the previous 12 month period, a reduction of 1.9%. Since its inception and through this August, the SBCV has received \$86.9 million in Cooperative Program contributions. More than 50% of these contributions have been forwarded to the Southern Baptist Convention for missions outside Virginia. In the SBCV's effort to allocate more monies to North American and International missions, in 2010 the amount forwarded to the SBC increased to 50.25% and the 2020 Vision Plan adopted last year included a proposal to increase CP by one-quarter of 1% annually until it reaches 52.5% by 2020. The SBCV has been blessed by its efficient operating structure and small support facilities and staff that enables it to forward to the SBC the second highest percentage of its receipts of any state convention in the Southern Baptist Convention. Most state conventions forward approximately 30% to 40% of their receipts to the SBC. Approximately 30% of the 1,863 SBC churches in Virginia are SBCV churches, which contribute 70% of all Cooperative Program and designated funds from Virginia. Of the 42 state conventions, the SBCV is the 15th largest contributor.

	SBCV	Non-SBCV	Total
Approximate Number of SBC Churches in Virginia	568	1,295	1,863
% of Virginia churches	30%	70%	100%
Cooperative Program Giving from VA churches	70%	30%	100%
Rank in \$ Contributions to CP by State Conventions	15		42
Rank in % Contributions to CP by State Conventions	2		42

COOPERATING AGREEMENTS WITH SBC PARTNERS

In addition to Cooperative Program contributions from affiliated SBCV churches, funds are provided by two Southern Baptist Convention partners. (1.) Funds from the North American Mission Board (NAMB) supplement SBCV monies for church planting. A challenge for the SBCV is NAMB's reallocation of its distribution of funds to all state conventions which began in the current year. This amount is being reduced from \$611,000 in 2009 to \$205,000 in 2011, amounting to a 66% reduction in NAMB funding. (2.) The other SBC partner is LifeWay Christian Resources which provides funds for church health resources.

In a cooperative spirit, our churches and members are encouraged to support LifeWay by utilizing their Bible study literature, music, church supplies, and other Christian resources. We also encourage sacrificial giving to NAMB's Annie Armstrong Easter Offering.

STATE MISSIONS OFFERING — Vision Virginia

The annual State Missions Offering receipts of over \$200,000 annually are an important source of funding that is over and above the Cooperative Program giving. This is designated annually to specific projects within the Commonwealth such as food distribution in Appalachia, disaster relief, church planting, property funding and worship equipment for church plants, church health workshops, personal evangelism, and ministry intern scholarships. The Vision Virginia goal for this year is \$350,000.

COVENANT OF PARTNERSHIPS (COP) — Churches Starting Churches

Our covenant churches and individual partners increased their designated gifts for financing new church starts by 23.5% to nearly \$1.15 million for the 12 months that ended August 2010. This sacrificial giving, over and above their regular cooperative program gifts, is essential to continue and maintain a healthy church planting partnership ministry. This extra outreach financial provision is very much appreciated.

CONTRIBUTIONS RECEIVED: Twelve Months Ending August 31

	<u>Last Year</u>	<u>This Year</u>	<u>Percent Change</u>
Cooperative Program Ministry Investment Plan	\$ 9,028,093	\$ 8,863,128	-1.9%
SBC Cooperating Agreements:			
North American Mission Board	\$ 635,290	\$ 567,942	-10.6%
LifeWay	\$ 79,996	\$ 79,996	0.0%
Special Offerings & Other Designated Gifts:			
Lottie Moon	\$ 2,825,428	\$ 2,880,457	+2.0%
Annie Armstrong	\$ 1,112,904	\$ 991,453	-11.0%
State Missions Offering "Vision Virginia"	\$ 216,277	\$ 206,375	-4.6%
Other Designated Contributions	\$ 287,037	\$ 477,50	+66.4%
Covenant Partnerships— Churches Starting Churches	\$ 931,637	\$ 1,149,845	+23.5%
TOTAL CONTRIBUTIONS	\$15,116,662	\$15,216,697	+ 0.7%

2011 PROPOSED COOPERATIVE PROGRAM \$ 9,000,000 MINISTRY INVESTMENT PLAN (MIP)

The Proposed Cooperative Program Ministry Investment Plan for calendar year 2011, in the amount of \$9,000,000, is to be funded by undesignated

Cooperative Program contributions from the SBCV churches. It is 2.2% less than the \$9,200,000 Plan for the current year. In its October meeting, the Executive Board, based on the current giving trends, decided to base the 2011 Ministry Plan on the same level as 2009 contributions. To balance the budget, it will be necessary to use about \$600,000 from "opportunity" funds held in reserves to meet our church planting commitments. Currently there is approximately \$3.3 million in reserve "opportunity" funds, of which approximately \$2.5 million will be used for the new Mission Support Center construction. The Ministry Plan expenses for the 12 months ending August 31, 2010 was \$9.7 million compared to \$10.1 million for the previous period. The total 2011 ministry investment including Cooperative Program gifts from our churches, designated contributions from our two SBC partners, and estimated funds that may be required from reserve "opportunity" funds, is estimated to be \$9,875,000. The Proposed 2011 Ministry Investment Plan is presented in the Annual Homecoming Guide immediately following this report.

CONCLUSION

As always, the SBCV missionaries and staff have done a commendable job of keeping expenses in line with receipts. We are most grateful for the continual faithfulness and generosity of the churches in supporting the Cooperative Program (CP) as well as the three special offerings, and the church planting financial support contributed over and above CP through the SBCV as we faithfully serve the Lord with gladness.

Proposed 2011 Cooperative Program Ministry Investment Plan

	2011 Ministry Plan Cooperative Program	2011 SBC Partners & Other Designated Funds	Total 2011 Ministry Investment Plan
MINISTRY CONTRIBUTIONS AND RECEIPTS			
COOPERATIVE PROGRAM CONTRIBUTIONS			
Southern Baptist Convention	4,545,000		4,545,000
SBC of Virginia	4,455,000		4,455,000
TOTAL COOPERATIVE PROGRAM	9,000,000		9,000,000
PARTNERSHIP CONTRIBUTIONS			
North American Mission Board		205,000	205,000
Lifeway Christian Resources		70,000	70,000
TOTAL PARTNERSHIP CONTRIBUTIONS		275,000	275,000
TOTAL STRATEGIC OPPORTUNITY FUNDS	—	600,000	600,000
GRAND TOTAL CONTRIBUTIONS AND RECEIPTS	\$9,000,000	\$875,000	\$9,875,000
MINISTRY INVESTMENT PLAN EXPENDITURES			
TOTAL SOUTHERN BAPTIST CONVENTION	4,545,000		4,545,000
SBCV DIRECT MINISTRY INVESTMENTS			
MULTIPLYING CHURCHES			
Missionary Salaries & Benefits	571,977		571,977
Ministry Related Expenditures	81,050		81,050
Field Preparation	9,000		9,000
Recruiting & Developing	20,000		20,000
Mentoring & Supporting	53,500		53,500
Strategic Initiatives	18,000		18,000
Financial Support for Planters	71,904	805,000	876,904
Other Multiplying Expenditures	40,200		40,200
TOTAL MULTIPLYING CHURCHES	865,631	805,000	1,670,631

Proposed 2011 Cooperative Program Ministry Investment Plan, continued

	2011 Ministry Plan Cooperative Program	2011 SBC Partners & Other Designated Funds	Total 2011 Ministry Investment Plan
MATURING CHURCHES			
Missionary Salaries & Benefits	738,393	55,000	793,393
Ministry Related Expenses	116,725	15,000	131,725
Multi Church Events	32,500		32,500
Church Leadership Development	12,500		12,500
Pastor Fellowships/Connections	27,500		27,500
Student Camps & Conferences	25,000		25,000
Student Leadership Development	11,500		11,500
Women's Networks/Regional Events	15,000		15,000
Pastor/Staff/Family Enrichment	7,500		7,500
Ministry to Staff Wives	11,750		11,750
Church and Minister Relations	11,250		11,250
Ministry Assist Teams	2,500		2,500
Mentoring/Power Lunches	12,500		12,500
Stewardship Education	5,000		5,000
Church Health Consultation	10,000		10,000
Seminary Scholarships	35,000		35,000
Retirement and Dependent Benefit	130,000		130,000
Evangelism Training & Resources	15,000		15,000
Vacation Bible School	15,000		15,000
Children's Ministry	5,000		5,000
Student Evangelism	32,250		32,250
Other Maturing Expenditures	30,000		30,000
TOTAL MATURING CHURCHES	1,301,868	70,000	1,371,868
MOBILIZING CHURCHES			
Missionary Salaries & Benefits	265,360		265,360
Ministry Related Expenses	28,050		28,050
Networking Leaders/Volunteers	9,200		9,200
Partnerships & Projects	34,450		34,450

Proposed 2011 Cooperative Program Ministry Investment Plan, continued

	2011 Ministry Plan Cooperative Program	2011 SBC Partners & Other Designated Funds	Total 2011 Ministry Investment Plan
Disaster Relief	10,000		10,000
Building Missions Awareness	8,500		8,500
Baptist Builders	3,500		3,500
TOTAL MOBILIZING CHURCHES	359,060		359,060
TOTAL SBCV DIRECT MINISTRY INVESTMENTS	2,526,559	875,000	3,401,559
TOTAL DIRECT MINISTRY INVESTMENTS	7,071,559	875,000	7,946,559
SBCV INDIRECT MINISTRY INVESTMENTS			
MEDIA SERVICES			
Personnel Salaries & Benefits	234,871		234,871
Ministry Related Expenditures	22,300		22,300
Publications	108,000		108,000
Cooperative Program Promotion	3,000		3,000
Creative Services	21,500		21,500
Website	7,500		7,500
Media Supplies	10,000		10,000
TOTAL MEDIA SERVICES	407,171		407,171
MINISTRY SUPPORT SERVICES			
Resource Services			
Personnel Salaries & Benefits	147,262		147,262
Facilities	326,500		326,500
Office Equipment & Supplies	21,880		21,880
Total Resource Services	495,642		495,642

Proposed 2011 Cooperative Program Ministry Investment Plan, continued

	2011 Ministry Plan Cooperative Program	2011 SBC Partners & Other Designated Funds	Total 2011 Ministry Investment Plan
Business Services			
Personnel Salaries & Benefits	383,715		383,715
Ministry Related Expenditures	15,000		15,000
Office Expenses	2,500		2,500
Audit & Legal	30,000		30,000
Total Business Services	431,215		431,215
Information Services			
Personnel Salaries & Benefits	114,996		114,996
Ministry Related Expenditures	7,200		7,200
Computer Hardware	65,500		65,500
Computer Software	10,000		10,000
Communication Services	49,300		49,300
Consulting Services	8,000		8,000
Total Information Services	254,996		254,996
TOTAL MINISTRY SUPPORT SERVICES	1,181,853		1,181,853
ADMINISTRATION			
Administrative Salaries & Benefits	231,917		231,917
Ministry Related Expenditures	17,500		17,500
Annual Meeting	60,000		60,000
Board and Committee Meetings	15,000		15,000
Leadership Meetings	15,000		15,000
TOTAL ADMINISTRATION	339,417		339,417
TOTAL SBCV INDIRECT MINISTRY INVESTMENT	1,928,441		1,928,441
GRAND TOTAL 2011 MINISTRY INVESTMENT PLAN	\$9,000,000	\$875,000	\$9,875,000

FOOTNOTES:

1. The proposed \$9 million 2011 Ministry Investment Plan is 2.22% less than the 2010 Ministry Investment Plan, and 0.41% less than projected Cooperative Program contributions for fiscal year ending December 31, 2010
2. \$4,545,000 or 50.50% of all undesignated Cooperative Program contributions will be invested monthly in direct missions through the Southern Baptist Convention distributed according to the SBC budget approved annually by church-authorized messengers attending the Annual Southern Baptist Convention
3. The \$4,455,000 or 49.50% SBCV portion of Cooperative Program contributions, the \$275,000 SBC partner contributions, and the \$600,000 strategic opportunity funds will fund the total direct and indirect SBCV Plan (\$5,330,000)
4. The Total SBCV Indirect Ministry Investment (\$1,928,441) is allocated on a percentage basis to the Total SBCV Direct Ministry Investment (\$3,401,559) to report the scope and level of our commitment toward fulfilling three strategic objectives of the SBCV:
 - \$2,617,759 or 49.11% will be invested in multiplying churches located within the five (5) Regions of the SBCV
 - \$2,149,619 or 40.33% will be invested in maturing churches within the five (5) Regions of the SBCV
 - \$562,622 or 10.56% will be invested in mobilizing churches to be engaged in Acts 1:8 missions and ministries
5. Fifty and one-half of 1% (50.50%) of Cooperative Program funds received in excess of \$9 million in 2011 will be forwarded to the Southern Baptist Convention
6. Any unexpended SBCV funds will be carried forward for future church planting and other strategic ministry opportunities

RECOMMENDATION: The Executive Board recommends to messengers in the 2010 Annual Homecoming that the Proposed 2011 Cooperative Program Ministry Investment Plan in the amount of \$9,000,000 be adopted.



Maturing Churches Report

Steve Bradshaw, Director of Maturing Churches

Mission Statement

The Maturing Churches Team exists to assist the local churches of the SBCV in enhancing relationships between pastors, staff and lay leaders and to assist them in becoming a healthier and growing congregation as they carry out the Great Commission of our Lord and Savior Jesus Christ.

Our Missionary Force

Church Health Strategists (CHS), Ministry Assistant, Associates (ACHS), and State Strategists

Southwest Region: Gary and Susan Horton

Central West Region: Jack and Rhonda Noble, Shawn Ames

Central East Region: Steve and Jan Bradshaw, Don Crain

North Region: Darrell and Angela Webb, Doug Stell

Southeast Region: David and Sharon Bounds (Interim), John Burr

Women's Ministry Strategist: Sue Sawyer

Student Ministry Strategist: Steve Maltempi

By the Numbers

Church Statistics: Church Health Indicators based on 2009 Annual Church Profiles

- Church Membership: Increased by (+.6%) to 205,164
- Evangelism Efforts: Baptisms increased by (+2.7%) to 6193
- VBS Participation increased by (+5.7%) to 48,769
- GPS Participation (216 Churches Reporting)
- Worship Attendance: Decreased by (-4.7%) to 101,714
- Small Group: Enrollment increased by (+9.7) to 109,644
- Missions: Involvement increased by (+22.6%) to 34,157
- Missions Giving reported a (+10.7%) increase
- Church Planting Activity (47 churches currently financially supporting Church Planting through the SBCV)

Missionary Activity: The Field Impact (December 1, 2009 – September 30, 2010)

- Preaching Engagements: 165
- Customized Church Leadership Trainings: 79
- Pastor, Staff, and Wives Connection Fellowships: 80 with 1,675 in attendance
- Pastor and Staff Power Lunch Fellowships: 162 with 846 in attendance
- One-on-One Mentoring: 344
- New Prospective Churches Discovered: 51
- SBCV / Missions Presentations Made: 33
- Newly Aligned Churches: 16



Vacation Bible School Clinics

SBCV provided 13 VBS Clinics across the state led by three trained teams that highlighted LifeWay's Saddle Ridge Ranch and Route 254 Club VBS Curriculums. There were over 800 in attendance.

Block Party and Sports Trailers

Block party and sports trailers are available for use throughout the year, but the summer months are peak season for their evangelistic usage. This year, in partnership with the North American Mission Board, the SBCV helped support seven summer interns who were deployed throughout the state to promote, oversee the usage and assist local churches in hosting an effective block party event. Of the reports received, there were 35 events, with approximately 6,650 in attendance and 76 first time decisions for Christ.

Stewardship

SBC Compensation Study

In partnership with GuideStone and LifeWay Christian Resources, SBCV pastors, ministerial staff and church staff were encouraged to participate in this year's Compensation Study. The data received from these surveys assist churches in determining a comparable compensation packet for their staff and employees.

"It's a New Day" for Financial Freedom Conference

In partnership with the Executive Committee of the Southern Baptist

Convention and Crown Financial, "It's A New Day" for Financial Freedom Conferences were offered in all five regions of our state. Nearly 100 pastors and lay leaders were able to glean Biblical principles in getting out of and staying out of debt that they will in turn share with their congregations.

Cooperative Program Resources

In partnership with the Southern Baptist Convention's Executive Committee and in agreement with the Great Commission Resurgence action taken at the 2010 Southern Baptist Convention, the SBCV has invested and is providing Cooperative Program resources. The familiar **Missionary Moments** prayer guide is being provided in 2011 along with a DVD that puts a name and face with the prayer needs of our missionaries. **The Gift** is a great tool to explain step by step how a church tithe reaches the mission field of the state, continent and the world. Also in partnership with sister state conventions, our Media department is producing Cooperative Program videos that will be relevant and connect with SBCV congregations.

State Events Summaries

- **SBCV Collegiate Winter Retreat** was held on **January 5-7** at Snowshoe Ski Resort in West Virginia with 56 students participating.
- **Youth Evangelism Conference** was held on **January 15-16** at London Bridge Baptist Church in Virginia Beach with 1,312 students in attendance, 34 salvation decisions and 55 rededications.
- **Pastors, Staff and Wives Retreat** was held on **February 12-13** at the Stonewall Jackson Hotel in Staunton with 63 couples representing 39 churches. Guest speakers were Dr. Rhonda Kelley of New Orleans



- Churches without Pastors: Range from 38-54
- Search Committee Trainings: 26
- Churches in Crisis: 37
- Church Health Workshops/Analysis: 22
- Churches Reporting Missions Activities: 286
- Churches Committed to Acts 1:8 Network: 82
- New Interests in Church Planting Discovered: 28
- Churches Committing to be Evangelism Response Centers: 80

Year end regional, Studentz and Women's Ministry reports will be available on the Maturing Webpage of the SBCV Website.

Vision 20/20

A maturing missional network ... in which at least 500 congregations progress to the next level of congregational health. Churches may be plotted along a spectrum of congregational health. These levels range from churches that are near dissolution to those that are impacting the world in transformational ways. The SBCV will partner with interested local congregations to facilitate an evaluation, prescription, and implementation of a course of action that will, by God's grace, enable them to reach the next level on the spectrum of congregational health.

Church Health

The Church Health Strategists helped devise a comprehensive Church Health Analysis that was revealed at the 2009 Annual Homecoming. The March-April 2010 edition of The Proclaimer gave a detailed explanation of that

process. Many pastors and staff are beginning to get their congregation's perspective of where they are on the congregational health spectrum. The E412 Equipping Conference on April 30 – May 1 introduced Transformed Leaders and Transformational Churches with Ed Stetzer as the keynote speaker. On October 21-22, the Church Health Strategists were certified as Transformational Church trainers. In January and February of 2011 multiple Church Health Workshops are being scheduled per region. This will give pastors, staff and lay leaders an opportunity to see how LifeWay's latest tool will aid in the Church Health Analysis. By a comprehensive diagnostic surveying of a sampling of the congregation, the plotting of the church's health will be more realistic and therefore the proper prescriptions can be administered in order to reach visionary outcomes.

Evangelism

God's Plan for Sharing Initiative

216 SBCV Churches reported participation in "God's Plan for Sharing", a 10 year North American Mission Board Evangelism and Outreach initiative that challenged churches to prayer walk, distribute Gospel tracts and invite their community to their church for a special Easter service. The SBCV in partnership with NAMB provided national media spots for the "Find It Here" commercials and reproduced the Gospel card and door bag at a cost of \$100 for 1,000. The SBCV also provided a template for a customized church invitation and gave each participating church a free "Find It Here" yard banner. In 2011, churches will be encouraged to repeat these activities and in 2012 the sub-theme will be "Hope: Find It Here" with an emphasis on attractional church events.



Baptist Theological Seminary and Dr. Bryan Smith, pastor of First Baptist Church, Roanoke.

- **Student Pastor Retreat** was held at Great Wolf Lodge, Williamsburg on **February 19-20** with Allen Jackson as the guest speaker. There were 156 attendees.
- **Going Beyond Conference** with Priscilla Shirer was held on **February 26-27** at the McLean Bible Church in Northern Virginia. There were over 2,500 women in attendance.
- **E412 Equipping Conference** was held on **April 30-May 1** at Swift Creek Baptist Church, Midlothian with over 800 attending plenary sessions with Jeff Iorg, Ed Stetzer and Bob Roberts, affinity groups and breakout sessions for all areas of ministry in the local church. The weekend also included a Super VBS Clinic, Disaster Relief Training and a Statewide Church Planting Network.
- **State Bible Drill and Speaker's Tournament** was held on **May 15** at Beulah Baptist Church, Lynchburg with children locating, memorizing and proclaiming the Word of God.
- **Studentz Mission Plant** - on mission in the Dakotas took place on **June 26-July 2**. 144 Students from SBCV churches assisted new Church Plants in North and South Dakota.
- **Studentz Camp** was held at Liberty University on **July 12-16** at Liberty University with Ken Freeman, Bluetree and Humble Tip as guest evangelist, worship leaders and artists. Over 800 students attended and 109 first time decisions for Christ were recorded.

- **Between Us Ministers Wives Conference** was held at the Richmond Coliseum on **August 26-27**. 135 attended the Living Proof pre-conference.
- **Beth Moore "Living Proof Live" Conference** took place at the Richmond Coliseum on **August 27-28** with over 9,000 in attendance.
- **Wildfire Men's Conference** was held on **September 17- 18** at Thomas Road Baptist Church, Lynchburg with more than 4,000 in attendance. SBCV staff and pastors provided 10 breakout sessions.



Multiplying Churches Report

Mark Custalow, Director

The Multiplying Churches Team exists to assist the churches of the SBC of Virginia to carry out the Great Commission by way of planting new churches. I rejoice in reporting to you today that the state of church planting in Virginia and Washington DC is strong, and our future remains bright.

Because the churches of the SBCV gave to the Cooperative Program, \$1,100,000 has been invested in the direct support of SBCV affiliated church plants. Additionally, 47 SBCV churches combined with other outside donors to contribute another \$1,173,000 in direct support of SBCV church plants over and above their giving to the Cooperative Program gifts. 22 SBCV churches began new financial partnerships with new and existing church plants. This giving reflects that SBCV churches are indeed committed to reaching communities across Virginia, Washington DC and other surrounding communities with the gospel through church planting. To God be the glory for your sacrificial gifts! We remain prayerful that even a greater percentage of our churches will engage in supporting new church plants over and above their Cooperative Program gifts in 2011.

The ministry area of the SBC of Virginia (including Washington DC) encompasses in excess of 10 million people, a number which continues to rise. In order to gain a better understanding of our harvest field and of the

mission before us, the SBCV has contracted with the Intercultural Institute for Contextual Ministry to conduct extensive research. The research indicates that only 10% of the population is active in any evangelical church, and merely 1.17% attends an SBCV church on an average Sunday. The research goes on to indicate conservatively that 70% of the population has no evangelical affiliation at all. Using extensive data sets, including 10 years of ACP data from all SBCV churches, we have identified the top 24 church planting sites per region for a total of 120 in Virginia and Washington DC. With this information, we will be able to assist SBCV churches to strategically invest their resources where the needs are greatest.

The SBCV is blessed to have a national quality team of church planting strategists whose job it is to assist our member churches to plant new churches. These strategists include:

Bill Wennersten — North Region
Joe Hernandez (Contractor) — North Region
Matt Gregory (Associate) — North Region
Ron Kidd — Central East Region
Mark Custalow — Southeast Region
Steve Swisher (Associate) — Southeast Region
Chris Gill (Associate) — Southeast Region
Vernig Suarez (Associate) — Southeast Region
Larry Black — Central West Region
Chris Dowd (Associate) — Central West Region
Randy Aldridge — Southwest Region



Each of these strategists has a high level of expertise and competence in combination with a passion to reach the lost through church planting, and they stand ready to assist your church in accomplishing its mission.

A significant opportunity which lies ahead for the churches of the SBCV is the planting of 400 churches in the next 10 years. Would you commit to pray for our churches as we follow His vision of reaching the lost in Virginia and Washington DC through planting 400 churches in the next 10 years? The need and opportunity are great ... can you see it?

Churches Planters Approved

October 1, 2009 – September 1, 2010

Name	Name of Church Plant	City of Church Plant
Jonathan Davis	Pillar Church of Locust Grove	Locust Grove
Sergio Guardia	Fuente de Vida-Danville	Danville
John Hayden	Access Church	Roanoke
Ricky Love	Matthew's Table	City of Richmond
Yong Jin Park	Renewal Community	Bristow
Clovis Pause	TBD	TBD
Erik Smith	Christ Community Church	Portsmouth

Lay Planters	Name of Church Plant	City of Church Plant
Jonge Agurto	Iglesia Bautista Buenas Nuevas	Alexandria
Eric Ashley	Bridge Point Community	Central West Region
Jim Martin	Nepali People Group	Roanoke
Joaquin Martinez	Iglesia Bautista Roca Eterna de Carolina Del Norte	Ramseur NC
Carlos Payan	Jesus es el Senor Iglesia Bautisa	Amherst
Fredy Polanco	Iglesia Bautista Roca Eterna de Stafford	Stafford
Jesus Rivas	Ministerio Hispano Manassas Baptist Church	Manassas
James Roberts	Emanuel Baptist Church	Southwest Region
Sergio Salvatori	Iglesia Baptista Roca Eterna de Woodbridge	Dumfries
Joshua Solovskoy	Restoration Family Church	Lynchburg

Church Planter Apprentices

Approved October 1, 2009 – September 1, 2010

Name	Name of Church Plant	City of Church Plant
Christian Bagley	Harmony Baptist Church	Suffolk
Jeremy Branham	Crosspointe Community Fellowship	Bluefield
Bill Bray	Charlottesville Community	Charlottesville
Roy Garza	Pillar Church of Dumfries	Dumfries
Glenn Hawkins	Family Life at Ashland	Ashland
Sean Pyle	Remnant Church	Richmond
Brady Rose	Aletheia-Richmond	City of Richmond
Kevin Struble	Bethel Baptist Church	Evington
Kyle Tower	Aletheia-Richmond VCU	City of Richmond



Church Receiving Eagle Awards

October 1, 2009 – September 1, 2010

Sponsor Churches

Church Plant

Aletheia–Richmond	Matthew's Table
Cave Springs Baptist	Christian Life Fellowship
Christian Life Fellowship.....	Emanuel Baptist
Deep Creek Baptist.....	Christ Community Church
Fork Baptist Church	Fuente de Vida Charlottesville
Grace Point Baptist	Jesus is Lord Baptist Church
Harvest Fellowship Baptist	Access Church
Hatchers Memorial Baptist	Renewal Community
Petsworth Baptist	Bridge Point Community
Pillar Church of Dumfries.....	Pillar Church of Locus Grove
Pleasant View Baptist.....	Jesus is Lord Baptist Church
Potomac Baptist	Family Bible Fellowship
Soul Purpose.....	Mosaic Church of Culpeper
Soul Purpose.....	Pillar Church of Locus Grove
Southside Baptist – Suffolk	Harmony Baptist Church
Spotswood Baptist	Grace Fellowship
Spotswood Baptist	Pillar Church of Locust Grove
Swift Creek Midlothian	Movement Church
Thomas Road Baptist	Fuente de Vida Danville
Upperville Baptist	Lifeline Church
Village Church of Midlothian	Nueva Esperanza



Mobilizing Churches Report

Mark Gauthier, Director of Mobilizing Churches

This year the SBCV is moving towards becoming a mobilizing missional network ... in which the number of congregations committed to the *Acts 1:8 Challenge* grows from approximately 50 to over 500. To assist more SBCV churches in developing an Acts 1:8 strategy we have begun the process of engaging Mission Service Corps (MSC) volunteers through NAMB. Five positions have been identified, job descriptions developed, and positions posted on the NAMB MSC website.

The **Disaster Relief** ministry continues to grow, adding 300+ newly trained volunteers in 2010. There has been a change in one leadership position: Bob Williams, First Baptist Church Norfolk has assumed the role of State Disaster Relief Strategist, a newly created position to work in concert with the State Director, Mark Gauthier. Additionally, the overall structure has been streamlined moving toward functional leadership (i.e. State Feeding Coordinator) rather than geographic leadership.

Since the last report DR volunteers have responded to disasters in New Hampshire, Massachusetts and Rhode Island floods, American Samoa for tsunami recovery and participated in Buckets of Hope for Haiti; sharing the Gospel at every opportunity. In response to the devastating earthquake, SBCV churches provided over 4,400 Buckets of Hope which fed 4,400 families in Haiti, each for one week, and sent one team to minister in Haiti.



Baptist Builders continues to grow with more than 400 active volunteers. They have participated in four projects (mobilizing more than 10 teams) this year;

The first project was a part of Operation NOAH in partnership with NAMB. The team was lead by Dave Williams from Grace Baptist Church, Virginia serving in New Orleans for one week. Thirty-three (33) volunteers from five SBCV churches participated in this opportunity.

Another major project took place at CommUNITY Church in Salem, VA. Numerous teams worked with church members erecting partitions, installing and finishing drywall, and installing new wiring in the newly acquired facility to meet building codes. Baptist Builders also provided several teams to Christian Life Fellowship in Jonesville working to convert a furniture store to a worship center. Families on Mission benefited from a team of Baptist Builders, working together in Big Stone Gap, constructing several wheel-chair ramps.

Additionally, three churches either have been or are in the process of having jobs evaluated for work by Baptist Builders.

Families on Missions was hosted by Oak Grove Baptist Church in Big Stone Gap, Virginia. The Families on Missions program is sponsored by the North American Mission Board and is essentially a turn key mission opportunity for our families to serve together. This gives parents or grandparents the chance to model missions and evangelism to our children, as young as 5 years old. Children ministered alongside family members as they met the physical and spiritual needs of the community. The event drew 97 participants from across the eastern United States!

FOM for 2011 will conclude its Big Stone Gap site and registration is open with families already signing up.

Campers on Mission (COM) is a national fellowship of Christian campers who share their faith and serve in various ways while they camp. The SBCV has begun to organize and promote COM this year and is excited about the upcoming year for this new (to SBCV) ministry opportunity! COM participates in short-term volunteer assignments across the United States and Canada. From state fairs and motor speedways to rural campgrounds, COM combines a love of the outdoors with ministry across North America. Visit the SBCV website for more information.

Mission Service Corps (MSC) are self-funded missionaries who serve for two years or more. They provide their own support in an assigned ministry that supports the evangelism and church planting efforts of the North American Mission Board (NAMB) and its mission partners. The placement comes through the Mission Service Corps office of the NAMB. SBCV currently has one MSC position filled, that of Recruiter/Trainer, and is actively seeking additional MSC missionaries to fill various Mobilizing Churches positions.

Missions Opportunities

Sue Sawyer, Associate Church Mobilization Strategist – Projects

VA Soldiers R&R Kits

Once again, this mission opportunity was a huge success. More than 1,612 kits were collected from 69 SBCV churches providing DVD's, snacks, devotional guides, tracts, and notes of encouragement to our Virginia soldiers serving in Afghanistan. SBCV churches have sent over 5,000 kits over the past 3 years.



Baptist Global Response (BGR) In-Home Care Kits

BGR seeks to meet acute needs internationally. These kits are used to provide much needed supplies for adults and children suffering with AIDS, cancer, TB, and other life-ending illnesses. The response was small for in-home care kits in light of overwhelming demand for SBCV churches giving to the Bucket of Hope for Haiti that occurred simultaneously. Great needs were met with both projects and that is the important results.

Witnessing Bracelets

These bracelets are used to share the Gospel at the Ocoee Outreach and Ocoee Resort Ministries in Southeast Tennessee. This year SBCV churches sent over 6,000 of these bracelets which were used to see hundreds of individuals come to receive Christ as personal Lord and Savior. SBCV churches have sent over 50,000 bracelets during the past few years.

Christian Libraries for Overseas

This is the second year that we have promoted this project to help strengthen and equip believers in third world, English speaking countries by providing biblically based materials, resources, and Bibles. SBCV churches have responded in an overwhelming way to this need by shipping and taking boxes of materials to Hand for Christ International in Roanoke.

Back-to-School Packs for ARM

In many parts of the Appalachian Region children begin their first day of school with no school supplies. Much joy and encouragement was given to over 650 children in that area through SBCV churches sending Back-to-School Packs filled with basic school supplies and many other items that will

aid them as they approach a new school year. These packs open many doors for the people at ARM (Appalachian Region Ministry) to share the Good News of Jesus with the children and their families.

Sport Shoes & Socks for Uruguay

The SBCV and IMB are partnering together to send teams to Uruguay to share the Good News of Jesus. Inexpensive sport shoes and socks for the impoverished children will open many doors for workers to share the Gospel and plant churches. Since we are in the middle of this project at the current time, we do not know the actual results but we anticipate the response from SBCV churches to be overwhelming.

English as a Second Language (ESL)

Our culture is changing rapidly and God is opening the doors wide for a much needed area of ministry: teaching English as a second language (ESL). SBCV is beginning to strategize as to the most effective way to offer leadership in this area of ministry and to encourage SBCV churches to participate. We are in the process of identifying churches that are actively participating in this ministry. In the near future we desire to have an ESL Strategist in each ministry area to offer training opportunities and networking with churches in their areas and a statewide ESL Strategist to give guidance to the area strategist.

Food Distribution Ministries

As our economy continues in a downturn and many individuals are without jobs, the demands on SBCV churches offering Food Distribution Ministries is great. With the help of NAMB World Hunger Funds and funds given by SBCV churches to our State Missions Offering, there are six SBCV churches



with very active Food Distribution Ministries. So far this year, these churches have recorded through this ministry: 16 salvations, over 2,000 evangelistic encounters, over 4,000 hot meals served, and over 12,000 individuals helped with grocery items. All SBCV churches have made this possible as you have given through the Cooperative Program and the SBCV State Missions Offering.

Mission Partnerships

Eddie Urbine, Associate Church Mobilization Strategist – Partnerships

Partnership opportunities are being developed in concert with IMB under the new model of reaching people groups rather than partnering with a specific country. Vision trips to Uruguay and Africa are being planned for early and mid 2011.

In the Dakotas several teams have ministered there including a youth team of more than 125. Once again, a team was mobilized to evangelize during Bike Week at Sturgis where more than 1100 bikers gave their lives to Christ.

A new opportunity to reach the District of Columbia has been developed with several trips planned to support church planting efforts in that city for 2011.

The **Acts 1:8 Network** was developed and launched this year, as a strategy of the Acts 1:8 Challenge. Networks are being established which will enable SBCV churches to work together, duplicating what many churches are already doing: reaching Jerusalem, Judea, Samaria and the Ends of the Earth with

the Gospel. Churches will be able to work together as partners to Pray, Give, Do and Go in each of the many network focuses. These will include international, as well as North American opportunities.

Each Network will have a leader along with Pray, Give, Do and Go coordinators from the various churches who desire to reach a specific community or people group. For example, a Network to Nicaragua may involve as many as six or seven churches in the Network; however, an individual from a non-network church who feels a burden for that country could also become a team member on a trip, a prayer warrior, or a participant in a project to support that Network. Each Network will have a web page on the SBCV website filled with information, opportunities, links and reports from the field.

The over-arching goal is to connect churches from across the state, which have a calling to reach the same people group, to work together.

In 2010 more than 30 churches have enrolled as Acts 1:8 Network churches bringing the total to just over 80 churches.

Cooperative Program Contributions Comparison

September 2009 to August 2010 and September 2008 to August 2009

*** Total CP includes only undesignated Cooperative Program Gifts to SBC and SBCV**

Reference Name	Senior Pastor	2010	2009
Abundant Hope-Gates NC	Jon Rissmiller	\$ 0	\$ 0
Adial-Faber	Michael Hevener	\$ 1,402.16	\$ 2,948.15
Alberene-Charlottesville	Jeff Cale	\$ 0	\$ 0
Aletheia-Harrisonburg	Paul Fiske	\$ 14,934.00	\$ 16,652.00
Aletheia-Norfolk	Jamie Limato	\$ 1,258.00	\$ 1,571.00
Aletheia-Richmond	Josh Soto	\$ 10,059.07	\$ 5,850.59
Alexander-Chesapeake	(pastorless)	\$ 29,999.44	\$ 28,569.85
All Nations-Roanoke	Matthew Murphy	\$ 2,000.97	\$ 2,270.07
Amelia-Amelia	Vernon Gilmer	\$ 26,654.09	\$ 24,870.08
Amissville-Amissville	Ed Taylor	\$ 18,759.13	\$ 24,092.31
Anchor-Mechanicsville	Ken Card	\$ 11,792.41	\$ 7,592.36
Apple Grove-Mineral	Ed Burkholder	\$ 7,719.54	\$ 6,728.99
Apple Valley-Berryville	Van Welton	\$ 1,914.08	\$ 0
Artesian-Big Stone Gap	Wayne Artrip	\$ 4,139.36	\$ 5,071.18
Averett-Buffalo Junction	Rodney W. Barwick	\$ 5,533.32	\$ 5,000.00
Bacon's Castle-Surry	Jimmy Acree	\$ 15,831.40	\$ 14,931.09
Bayview-Norfolk	Cary Paulk	\$ 5,712.94	\$ 2,300.17
Beaverdam-Beaverdam	Gary Stewart	\$ 6,666.64	\$ 9,166.63
Bedrock-Bedford	Jonge Tate	\$ 21,867.02	\$ 10,760.61
Beech Grove-Galax	Mark Carico	\$ 1,500.00	\$ 1,500.00
Bermuda-Chester	Pete Hypes	\$ 10,995.17	\$ 11,441.56
Bethany Place-Richmond	Brandton Wood	\$ 42,805.12	\$ 65,637.54
Bethany-Portsmouth	Gene Primm	\$ 4,941.00	\$ 16,011.00
Bethel-Bloxom	(pastorless)	\$ 8,592.46	\$ 9,609.78
Bethel-Chesapeake	Reggie Hester	\$ 80,996.05	\$ 108,819.51

Cooperative Program Contributions Comparison, continued

Reference Name	Senior Pastor	2010	2009
Bethel-Evington	Mike Smith	\$ 1,973.30	\$ 2,873.51
Bethel-Yorktown	David Bounds, Interim	\$247,297.02	\$245,524.08
Bethlehem-Dillwyn	Grady Johnston	\$ 5,200.00	\$ 250
Bethlehem-Evington	James Crewe	\$ 1,500.00	\$ 1,500.00
Beulah-Kents Store	Jason Taylor	\$ 13,586.00	\$ 11,041.18
Beulah-Lynchburg	Butch McCarthy	\$ 67,147.75	\$ 77,774.79
Bible Believing-Richmond	John Taylor	\$ 75	\$ 0
Blackwater-Virginia Beach	Greg Hammer	\$ 3,000.00	\$ 3,000.00
Blue Ridge-Galax	David Moore	\$ 6,519.16	\$ 6,667.34
Boones Mill-Boones Mill	Richard Harrell	\$ 22,174.25	\$ 13,886.25
Boyce-Boyce	Ben Jenkins	\$ 9,050.61	\$ 11,565.00
Bradley Street-Bristol	(pastorless)	\$ 0	\$ 0
Brambleton-Roanoke	Tim Spear	\$ 310.92	\$ 600
Brent-Lox-Chesapeake	Ray Hall	\$ 8,323.36	\$ 1,057.29
Bridge of Hope-Abingdon	Danny Thompson	\$ 662.6	\$ 0
Bridge-Silver Spring MD	Jumaine Jones	\$ 10,015.00	\$ 6,465.00
Broadway-Onancock	Bob Smoot	\$ 1,606.00	\$ 1,384.18
Brook-Virginia Beach	David Howard	\$ 0	\$ 0
Brush Creek-Independence	Edgar Roland	\$ 7,565.75	\$ 7,091.41
Calvary Road-Alexandria	David Rhodenhizer	\$ 13,000.00	\$ 12,000.00
Calvary Road-Chesapeake	Harry Vanderford	\$ 12,276.40	\$ 12,106.99
Calvary-Altavista	Bobby Brumfield	\$ 3,660.84	\$ 19,949.40
Calvary-Charlottesville	Roi Savaiinaea	\$ 0	\$ 0
Calvary-Galax	James Billings	\$ 600	\$ 500
Calvary-Harrisonburg	John Welborn	\$ 0	\$ 0
Calvary-Portsmouth	Philip Parker	\$ 40,783.28	\$ 35,780.36
Calvary-Pound	Ron Leach	\$ 0	\$ 0
Calvary-Staunton	Randy Spencer	\$ 68,215.15	\$ 80,861.33
Calvary-Stonega	Matthew Marcus	\$ 1,952.00	\$ 1,571.00
Campbell Avenue-Lynchburg	Reed Ness	\$ 5,693.72	\$ 5,412.85
Capron-Capron	(pastorless)	\$ 8,563.67	\$ 8,679.72

Cooperative Program Contributions Comparison, continued

Reference Name	Senior Pastor	2010	2009
Cardinal-Ruther Glen	John Boquist	\$ 6,701.68	\$ 3,754.87
Carrollton-Carrollton	Lee Hess	\$ 13,940.98	\$ 15,322.66
Cartersville-Cartersville	Mark McClung	\$ 6,000.00	\$ 5,000.00
Cave Spring-Roanoke	Pete Schemm, Interim	\$220,815.74	\$247,370.77
Cedar Bluff-Atkins	Eddie Beck	\$ 28,840.00	\$ 28,054.00
Celebration-Virginia Beach	Bill Stafford III	\$ 0	\$ 0
CenterPoint-Mechanicsville	Mike Cauthorne	\$ 9,903.97	\$ 3,880.00
Centreville-Centreville	Billy Ross	\$145,169.77	\$139,214.00
Charity-Prince George	Wayne Henry	\$ 3,416.00	\$ 1,000.00
Charlottesville-Charlottesville	Kyle Hoover	\$ 6,796.47	\$ 3,581.45
Chatmoss-Martinsville	Rodney Houston	\$ 325.50	\$ 213.50
Chester Gap-Chester Gap	David Johnson	\$ 7,312.00	\$ 10,292.00
Christ First-Norfolk	Joe Spear	\$ 80	\$ 0
Christian Life-Jonesville	Randy Aldridge	\$ 5,674.42	\$ 4,383.70
Christiansburg-Christiansburg	(pastorless)	\$ 6,548.70	\$ 9,312.39
Christian-Swoope	Gary Hodges	\$ 3,480.00	\$ 2,700.00
Claremont-Claremont	Dawson Bailey	\$ 2,600.00	\$ 2,300.00
Clearview-Martinsville	Ronald Gardner	\$ 600	\$ 600
Clifton-Clifton	Bill McMahon, Interim	\$ 4,328.00	\$ 5,473.00
Clover-Clover	Lloyd Moore	\$ 2,000.00	\$ 2,000.00
Collinswood-Portsmouth	Jack Stallings	\$ 2,500.00	\$ 1,640.00
Colonial Heights-Colonial Heig	Randy Hahn	\$166,248.31	\$159,999.96
Colonial-Newport News	Ken Coleman	\$ 325	\$ 0
Common Ground-Portsmouth	Roger Allen	\$ 6,393.00	\$ 13,935.00
Community-Collinsville	Michael Harrison	\$ 15,509.15	\$ 12,609.96
Community-Orange	J.D. Scott	\$ 890.94	\$ 991.54
Community-Rustburg	Chris Weidley	\$ 5,142.72	\$ 4,773.90
CommUnity-Salem	Thomas McCracken	\$ 4,915.44	\$ 4,608.50
Concord-Charlotte Court House	Donnie Smith	\$ 4,989.75	\$ 0
Concord-Farmville	Rick Caldwell	\$ 13,000.00	\$ 13,546.00
Connelly-Roanoke	Don Pegram, Interim	\$ 4,534.16	\$ 5,203.60

Cooperative Program Contributions Comparison, continued

Reference Name	Senior Pastor	2010	2009
Corner Stone-Monroe	Peyton Fitzgerald	\$ 5,838.00	\$ 4,185.00
Cornerstone-Chase City	Norman Simmons	\$ 5,272.39	\$ 6,092.62
Cornerstone-Fredericksburg	Todd Pyle	\$ 11,377.57	\$ 8,652.31
Cornerstone-Newport News	Bob Haggerty	\$ 0	\$ 0
Covenant-Fredericksburg	Tom Strode	\$ 1,800.00	\$ 2,600.00
Covenant-Martinsville	T.A. Powell, Interim	\$ 800	\$ 1,000.00
Covenant-Pulaski	Larry Lindsey-Lay Elder	\$ 0	\$ 2,976.25
Craig Valley-New Castle	Bill Grindstaff	\$ 9,286.50	\$ 8,378.80
Crooked Oak-Hillsville	Oscar Hill	\$ 1,598.66	\$ 1,226.39
Crosspointe-Bluefield	Roger Cook	\$ 1,013.00	\$ 635
Crossroads-Abingdon	John Stapleton	\$ 1,188.57	\$ 77.50
Crossroads-Leesburg	Interim	\$ 5,975.00	\$ 11,149.00
Crossroads-Norfolk	Kevin Tremper	\$ 0	\$ 30
Crossroads-Richmond	Don Hughes	\$ 3,900.00	\$ 3,600.00
Crystal Spring-Roanoke	John Graybill	\$ 6,988.82	\$ 6,696.18
Cullen-Cullen	Robert Matz	\$ 663	\$ 0
Dale City-Dale City	Perry Jordan	\$ 21,515.59	\$ 9,656.70
Daleville-Daleville	Andy Cobb	\$ 4,401.00	\$ 4,268.00
DC Urban-Rockville MD	Cristian Pablo	\$ 0	\$ 2,315.08
De Las Americas-Lynchburg	Carlos Payan	\$ 4,359.00	\$ 4,453.96
DeBaun-Chesapeake	C.W. Mann	\$ 50	\$ 2,655.65
Deep Creek-Chesapeake	Ernie Myers	\$ 92,285.00	\$ 99,975.21
Deep Springs-Dryden	Rick Phillips	\$ 1,741.41	\$ 1,712.46
Deer Park-Newport News	Jonathan Judy	\$ 10,483.40	\$ 17,050.60
Deerfield-Deerfield	Curtis Crawford, Interim	\$ 2,573.14	\$ 565
Del Ray-Alexandria	Paul Douglas	\$ 7,207.61	\$ 5,537.65
Diamond Hill-Moneta	Ken Butterworth	\$ 500	\$ 0
Discipleship-Buena Vista	Tom Phelps	\$ 732.50	\$ 531
Dolphin-Dolphin	Marvin Lewis	\$ 11,870.84	\$ 11,540.75
East End-Roanoke	Troy Mueller	\$ 5,240.38	\$ 2,094.10
East Galax-Galax	Kenneth King	\$ 306.65	\$ 335.47

Cooperative Program Contributions Comparison, continued

Reference Name	Senior Pastor	2010	2009
East Stone Gap-East Stone Gap	Lonnie Brooks	\$ 6,048.00	\$ 6,508.00
Ebenezer-Callaway	Billy Shively	\$ 8,656.87	\$ 9,511.13
Ebenezer-Gloucester	Richard Ford	\$ 40	\$ 20,938.00
Edge Hill-Hurt	Chris Brooks	\$ 600	\$ 0
Edward Avenue-Waynesboro	Gary May	\$ 9,089.70	\$ 8,426.87
Ekklesia-Blacksburg	Doug Short	\$ 4,118.00	\$ 3,403.00
El Camino-Richmond	(pastorless)	\$ 894.59	\$ 906.38
El Refugio-Richmond	Jason Carlisle	\$ 862	\$ 1,262.00
El Shaddai-Bristol	(pastorless)	\$ 629.68	\$ 1,840.24
Eley's-Fredericksburg	James Coleman	\$ 0	\$ 0
Emmanuel-Manassas	(pastorless)	\$ 50,246.91	\$ 64,384.19
Emmanuel-Roanoke	Ron Buchanan	\$ 0	\$ 0
Emmanuel-St. Charles	James Roberts	\$ 299	\$ 0
Emmanuel-Virginia Beach	Wold Zemedkum	\$ 0	\$ 0
Enon-Chester	Doug Echols	\$ 45,973.00	\$ 36,057.00
Essential-Virginia Beach	Steve Swisher	\$ 28,555.00	\$ 10,458.00
Eternal-Centreville	Joseph Kim	\$ 0	\$ 0
Euclid-Bristol	Robert Jones	\$ 72,622.30	\$ 65,633.32
Evergreen-Evergreen	Chris King	\$ 35,160.00	\$ 36,384.00
Exmore-Exmore	Jonathan Carpenter	\$ 12,184.00	\$ 12,892.00
Fair Havens-Chesterfield	Bob McEachern	\$ 1,300.00	\$ 0
Fairview-Portsmouth	(pastorless)	\$ 3,935.31	\$ 3,679.69
Fairway-Haymarket	John Fletcher, Interim	\$ 0	\$ 4,209.30
Faith-Buchanan	Randy Martin	\$ 0	\$ 0
Faith-Lexington	William Thomas, Interim	\$ 5,693.68	\$ 6,699.22
Faith-Mathews	Werlie Hendrix	\$ 11,669.94	\$ 11,191.17
Faith-Richmond	Bruce Pratt	\$ 5,200.00	\$ 4,000.00
Faith-Salem	Jr. Westmoreland	\$ 5,878.73	\$ 5,060.47
Faith-Stafford	Tony Vinson	\$ 8,567.00	\$ 9,583.85
Faith-Stephens City	Thomas Hensley	\$ 11,666.33	\$ 13,276.03

Cooperative Program Contributions Comparison, continued

Reference Name	Senior Pastor	2010	2009
Falling Creek-Richmond	Jeff Beard	\$ 3,921.00	\$ 720
Falling Water-Marion	Jerry Creasy	\$ 4,420.52	\$ 4,961.89
Family Bible-Ashburn	Jason Walker	\$ 972.77	\$ 127
Family Bible-Virginia Beach	Bon Wong	\$ 600	\$ 800
Family Life-Aylett	John Agostino	\$ 4,464.82	\$ 0
Family Life-Mechanicsville	Paul McDaniel	\$ 6,459.92	\$ 7,797.52
Fellowship-Mechanicsville	(pastorless)	\$ 580.90	\$ 0
Fellowship-Salem	Ken Nienke	\$106,572.68	\$127,521.26
Fellowship-Spotsylvania	Jerry Hall	\$ 3,768.84	\$ 2,751.00
Fil-Am-Alexandria	Rolly Estabillio	\$ 2,800.00	\$ 0
Fincastle-Fincastle	Kevin Cummings	\$ 26,500.36	\$ 39,201.70
Fincastle-Tazewell	Greg DeMarco	\$ 11,734.99	\$ 9,619.23
Finney-Honaker	Stephen Musick	\$ 1,950.00	\$ 1,800.00
First Romanian-Dumfries	Emil Bartos, Interim	\$ 1,100.00	\$ 1,860.00
First Russian-Richmond	Alexander Kurmayev	\$ 298.90	\$ 1,483.70
First Southern-Hurt	(pastorless)	\$ 3,000.00	\$ 3,000.00
First-Bassett	Lew Bennett	\$ 18,000.00	\$ 18,000.00
First-Damascus	Wayne Guynn	\$ 27,317.44	\$ 33,861.50
First-Emporia	George Hughes	\$ 4,000.00	\$ 4,700.00
First-Millstone, Nathalie	Robert Blake	\$ 7,955.94	\$ 8,010.24
First-New Church	Bobby Parks	\$ 3,885.29	\$ 3,248.32
First-Norfolk	Eric Thomas	\$159,314.08	\$172,560.50
First-Pennington Gap	Josh Osteen	\$ 0	\$ 0
First-Pound	Jerry Lusk	\$ 0	\$ 1,400.00
First-Roanoke	Bryan Smith	\$369,983.78	\$387,859.24
First-St. Charles	Paul Davis	\$ 12,206.60	\$ 11,234.61
First-Suffolk	(pastorless)	\$ 84,023.00	\$ 92,139.00
Fishersville-Fishersville	Tom Cribb, Interim	\$ 25,497.63	\$ 25,452.40
Flat Gap-Pound	Robert Addington	\$ 2,267.01	\$ 3,318.39
Flat Ridge-Cana	Dennis Bledsoe	\$ 600	\$ 650
Florence-Oxford NC	(pastorless)	\$ 2,316.65	\$ 0

Cooperative Program Contributions Comparison, continued

Reference Name	Senior Pastor	2010	2009
Fluvanna-Scottsville	Alan Acree	\$ 20,946.15	\$ 21,825.10
Forest Hill-Skippers	(pastorless)	\$ 12,242.13	\$ 7,186.04
Forest Lawn-Danville	Tim Rogers	\$ 2,582.36	\$ 3,089.33
Forest-Forest	Tyler Scarlett	\$ 33,159.35	\$ 62,629.95
Fork-Bumpass	(pastorless)	\$ 5,553.10	\$ 2,331.76
Fork-Scottsburg	David Rathel	\$ 7,205.75	\$ 6,827.87
Foundations-Chesapeake	James Hewitt	\$ 3,680.09	\$ 3,167.64
Fox Hill Road-Hampton	Tommy Larson	\$ 2,633.43	\$ 0
Free Union-Free Union	Kevin Gift	\$ 2,235.00	\$ 2,450.43
Freedom-Fancy Gap	Charles Bunn	\$ 1,900.00	\$ 2,050.00
Freedom-Lynchburg	John Thompson	\$ 500.01	\$ 750
Fries-Fries	John Williams	\$ 10,410.00	\$ 14,167.00
Fuente-Charlottesville	Daniel Bannister	\$ 1,198.69	\$ 636.88
Furnace Creek-Rocky Mount	Michael Lawhorn	\$ 11,312.17	\$ 19,099.73
Geneva Park-Chesapeake	Mike Ellis	\$ 0	\$ 0
Glade Creek-Blue Ridge	Philip Ayers	\$ 2,158.00	\$ 1,992.00
Glen Hill-Ringgold	Stephen Wright	\$ 2,400.00	\$ 2,400.00
Glen Lyn-Glen Lyn	Jerry Rice	\$ 436.46	\$ 200.92
Glenwood-Troutdale	Tim Brown	\$ 600	\$ 800
Glenwood-Virginia Beach	Frank Howlett	\$ 1,200.00	\$ 1,500.00
God's Storehouse-Chesterfield	Tom Lovorn	\$ 10,961.03	\$ 11,384.07
Good Hope-Spotsylvania	Scott Quinn	\$ 7,848.24	\$ 5,400.00
Good News Korean-Annandale	Young Park	\$ 0	\$ 929
Good News-Alexandria	Calvert Wallace	\$ 8,910.00	\$ 13,477.00
Good Shepherd-Christiansburg	Matthew Kirkland	\$ 2,400.00	\$ 7,500.00
Grace Harvest-Amelia	Mark Wells	\$ 19,363.82	\$ 13,586.85
Grace-Abingdon	Steve Byrd	\$ 3,930.00	\$ 2,100.00
Grace-Altavista	Dave Christy	\$ 3,647.70	\$ 3,294.37
Grace-Bristol	Robert Howard	\$ 1,675.83	\$ 1,715.35
Grace-Charlottesville	Johnny Hartless	\$ 0	\$ 0
Grace-Fries	Ben Haga	\$ 4,906.74	\$ 4,397.59

Cooperative Program Contributions Comparison, continued

Reference Name	Senior Pastor	2010	2009
Grace-Gainesville	Rod Fultz	\$ 946.92	\$ 2,632.02
Grace-Haysi	Jeremiah Sluss	\$ 1,859.25	\$ 398.3
Grace-New Castle	Jere King	\$ 1,200.00	\$ 1,200.00
Grace-Pennington Gap	George Penley	\$ 1,553.00	\$ 829
GracePointe-Madison Heights	Greg Tyree	\$ 0	\$ 82
Gracepoint-Wise	Rob Haynes	\$ 11,955.19	\$ 6,514.44
Grace-Richmond	Guy Holloway	\$ 12,468.76	\$ 16,359.67
Grace-Stuart	Ted Thisse	\$ 10,032.05	\$ 8,101.95
Grace-Tappahannock	Shane Gallagher	\$ 4,176.00	\$ 0
Grace-Virgilina	Jack Stewart	\$ 65,591.42	\$ 46,114.70
Grafton-Yorktown	David Price, Interim	\$ 8,293.53	\$ 8,506.91
Great Neck-Virginia Beach	Todd Holt	\$ 31,006.43	\$ 37,523.15
Green Ridge-Roanoke	Michael Palmer	\$ 57,132.00	\$ 55,316.00
Green Run-Virginia Beach	Shane Martin	\$ 0	\$ 3,322.78
Grove Avenue-Richmond	Mark Becton	\$294,178.83	\$286,494.33
Grove-Goldvein	Ron Roach	\$ 5,564.15	\$ 5,875.74
Guilford Hispanic-Sterling	Fredy Hernandez	\$ 2,310.00	\$ 1,691.00
Guilford-Sterling	Michael McKinley	\$ 500	\$ 205
Gunston-Lorton	Lynn Hall	\$ 510	\$ 180
Hamilton-Hamilton	Tim White	\$ 98,739.34	\$129,438.11
Hampstead-MD	Chris Brammer	\$ 13,050.00	\$ 6,500.00
Hampton Roads-Hampton	John Corson, Interim	\$ 10,280.90	\$ 10,181.99
Hanover-King George	Rick Crookshank	\$ 9,000.00	\$ 8,340.00
Harmony-Suffolk	Steven Hills	\$ 1,380.93	\$ 0
Harvest-East Stone Gap	(pastorless)	\$ 151.91	\$ 0
Harvest-Mechanicsville	Joel Bradberry	\$ 87,789.10	\$ 0
Harvest-Petersburg	Larry Murray	\$ 4,639.33	\$ 3,781.12
Harvest-Smithfield	Randy Green	\$ 60,051.94	\$ 46,059.66
Haw Orchard-Mouth of Wilson	Randy Lovelace	\$ 0	\$ 800
Hebron-Gore	John McKinney	\$ 800	\$ 500
Hebron-Spotsylvania	Bob Ellinger	\$ 3,000.00	\$ 3,000.00

Cooperative Program Contributions Comparison, continued

Reference Name	Senior Pastor	2010	2009
Heritage-Norfolk	Dennis Walker	\$ 0	\$ 1,280.00
Hickory Ridge-Chesapeake	Calvin Corbitt	\$ 4,410.00	\$ 4,340.00
Highland-Portsmouth	Kevin Wilson	\$ 1,830.79	\$ 1,549.13
Highlands-Abingdon	Jimmie Davidson	\$ 13,000.00	\$ 12,000.00
Hill Memorial-Martinsville	Bill Moss	\$ 3,326.30	\$ 4,884.26
Hillcrest-Ridgeway	Doug Ramsey	\$ 58,701.12	\$ 62,464.16
Hillcrest-Temple Hills MD	(pastorless)	\$ 26,000.00	\$ 7,000.00
Hope Aglow-Lynchburg	John Allen	\$ 0	\$ 0
Hopeful-Montpelier	Bruce Cole	\$ 10,000.00	\$ 10,000.00
Hopewell-New Kent	Vander Warner, Interim	\$ 11,978.33	\$ 8,436.11
Hyland Heights-Rustburg	Carl Weiser	\$ 92,629.69	\$ 136,557.09
Iglesia Centreville-Centreville	Ricardo Carrillo	\$ 3,693.25	\$ 3,996.33
Iglesia Emanuel -Manassas	Eliezer Perez	\$ 7,431.44	\$ 8,101.15
Iglesia Hillcrest-Ridgeway	Tim Harville	\$ 1,107.94	\$ 111
Iglesia Misionera-Richmond	Tim Amador	\$ 1,000.00	\$ 600
Iglesia-Hyattsville MD	Christian Pablo	\$ 1,963.21	\$ 1,391.48
Immanuel-Chesapeake	Dave Libengood	\$ 9,473.47	\$ 13,355.05
Indian River-Chesapeake	Bob Jordan	\$ 9,558.89	\$ 10,331.20
Indo Pak-Lanham MD	Allen Timothy	\$ 880	\$ 706
Ingleside-Norfolk	Peter McLewin	\$ 0	\$ 103
International-Alexandria	Tom Cano	\$ 3,719.00	\$ 4,058.00
Ironbridge-Chesterfield	Mark Jordan	\$ 46,611.80	\$ 60,781.15
Island-Chincoteague	Nathan Walker	\$ 1,875.00	\$ 1,800.00
Ivy Farms-Newport News	Ray Slone	\$ 0	\$ 0
Ivy Spring-Swords Creek	Phillip Cook	\$ 400	\$ 300
Jefferson Park-Charlottesville	(pastorless)	\$ 14,039.63	\$ 22,653.73
Jeffersonton-Jeffersonton	Dennis Smith	\$ 14,000.00	\$ 13,666.72
Jerusalem-Fairfax Station	Terry Smith	\$ 20,456.19	\$ 20,640.85
Jesus de Nazaret-Richmond	Luis Cruz	\$ 0	\$ 734.31
Keeling-Keeling	Tom Bailey	\$ 449.78	\$ 2,416.00
Kempsville-Virginia Beach	Kelly Burris	\$ 89,968.86	\$ 69,967.39

Cooperative Program Contributions Comparison, continued

Reference Name	Senior Pastor	2010	2009
Kerr's Creek-Lexington	Zebby Volpe	\$ 3,747.00	\$ 7,315.00
Kingdom-Fredericksburg	Craig Polston	\$ 4,150.01	\$ 7,840.84
Kings Highway-Fredericksburg	Carlin Dempsey	\$ 440.28	\$ 1,953.83
Kingsland-Richmond	Pat Fiordelise	\$ 60,000.00	\$ 60,000.00
Kingsway-Bristol	Todd Freeman	\$ 4,250.00	\$ 5,115.20
Knotts Island-Knotts Island	Scott Manns	\$ 4,920.00	12,764.59
Koinonia-Chester	Juan Veslasquez	\$ 0	\$ 0
Korean American-Alexandria	Dongsoon Moon	\$ 0	\$ 0
Korean Mission-Hopewell	Paul Chang	\$ 0	\$ 0
Ladysmith-Ladysmith	James Eads	\$ 0	\$ 0
Lake Anna-Bumpass	Sam Sieg	\$ 7,195.07	\$ 7,651.29
Lake Drummond-Chesapeake	Buddy Hoggard	\$ 12,600.00	\$ 4,525.00
Lambsburg-Lambsburg	(pastorless)	\$ 0	\$ 1,294.00
Laurel Hill-Earlysville	Bruce Goldsmith	\$ 10,999.96	\$ 11,000.04
Laurel Hill-Mouth of Wilson	Harlan Greer	\$ 0	\$ 0
Leawood-Lynchburg	Lenn Lloyd	\$ 0	\$ 0
Liberty Chapel-Appomattox	(pastorless)	\$ 1,600.00	\$ 1,600.00
Liberty Hill-Troutdale	Tim Boyette	\$ 5,300.14	\$ 4,081.67
Liberty-Appomattox	Rusty Small	\$ 55,992.68	\$ 52,645.54
Liberty-Hampton	Grant Ethridge	\$247,809.30	\$389,807.85
Liberty-Hopewell	Phil Andrews	\$ 2,166.71	\$ 1,831.34
Liberty-Lanexa	Mark Hollingsworth	\$ 33,573.41	\$ 46,670.24
Liberty-Suffolk	David Blevins	\$ 780	\$ 780
Life at Zion-Charlottesville	Stephen Reynolds	\$ 1,200.00	\$ 1,200.00
Life Pointe-Roanoke	Edgar Moser	\$ 0	\$ 0
Lifeline-Richmond	Dallas Mills	\$ 8,168.14	\$ 3,635.75
Lifepoint-Fredericksburg	Daniel Floyd	\$ 16,666.10	\$ 9,915.78
LifeSong-Harrisonburg	(pastorless)	\$ 6,605.87	\$ 4,659.00
Life-Woodbridge	Steve Markle	\$ 3,000.00	\$ 1,750.00
Light of Hope-Blackstone	Ronnie West	\$ 0	\$ 0
Light of the World-Chesterfield	Paul Chipman	\$ 770	\$ 3,784.20

Cooperative Program Contributions Comparison, continued

Reference Name	Senior Pastor	2010	2009
Lighthouse-Jonesville	Matthew Thompson	\$ 1,864.73	\$ 2,094.97
Lime Hill-Bristol	(pastorless)	\$ 2,188.10	\$ 1,954.94
Little River-Bumpass	Tim Chrisman	\$ 10,999.31	\$ 13,855.76
Lively Stones-Pelham NC	Michael Kent	\$ 0	\$ 100
Living Proof-Williamsburg	Eric Scholten	\$ 5,683.00	\$ 7,620.00
Living Water-Laurel MD	Art Thompson	\$ 90	\$ 0
Living Word-Forest	Marvin Suitt	\$ 3,600.00	\$ 3,600.00
London Bridge-Virginia Beach	(pastorless)	\$130,000.00	\$131,666.85
Longdale-Eagle Rock	Grover Stevens, Interim	\$ 1,400.00	\$ 1,400.00
Lord's-Fredericksburg	Jim Weadon	\$ 2,000.00	\$ 1,500.00
Lower Rapidan-Rapidan	(pastorless)	\$ 0	\$ 0
Main Street-Christiansburg	Tim Hight	\$ 92,706.03	\$ 83,763.81
Maranatha-Exmore	Mike Muender	\$ 250	\$ 0
Maranatha-Windsor	Clyde Alderman	\$ 304.90	\$ 284.02
Marion-Chatham	Henry Meadows	\$ 22,746.30	\$ 15,824.80
Matoaca-Matoaca	Donnie Joyner	\$ 42,004.26	\$ 75,570.31
Mayflower-Roanoke	Eddie Dean	\$ 2,329.52	\$ 2,236.94
Maysville-Buckingham	David Reid	\$ 5,000.00	\$ 14,000.00
Mecklenburg-South Hill	Andy Davis	\$ 2,644.28	\$ 3,024.94
Memorial-Columbia	William Bess	\$ 830.9	\$ 1,094.74
Memorial-Louisa	Jim Blackwell	\$ 4,678.62	\$ 4,603.80
Memorial-Port Royal	(pastorless)	\$ 5,926.00	\$ 5,873.00
Memorial-Pulaski	David Lones	\$ 8,960.00	\$ 11,057.00
Menchville-Newport News	Jim Weston Jr	\$ 15,614.73	\$ 12,156.51
Metro DC-Alexandria	Darwin Sokoken	\$ 697	\$ 0
Middle Fork-Chilhowie	Roscoe Greer	\$ 541.67	\$ 500
Midway-Galax	Myron Dalton	\$ 1,250.00	\$ 0
Midway-Mount Airy NC	Larry Phillips	\$ 461.25	\$ 584
Midway-Phenix	Joey Anthony	\$ 9,653.12	\$ 9,089.33
Mill Creek-Chatham	Lee Harris	\$ 4,000.00	\$ 4,000.00
Mill Creek-Henry	Sam Johnston	\$ 1,500.00	\$ 1,500.00

Cooperative Program Contributions Comparison, continued

Reference Name	Senior Pastor	2010	2009
Mill Swamp-Ivor	James Jones	\$ 35,177.44	\$ 36,595.24
Mineral Springs-Gladstone	Odell Coggins	\$ 2,000.00	\$ 2,000.00
Mineral Springs-Vinton	Andy Rice	\$ 13,199.94	\$ 25,600.00
Monumental-Petersburg	Barry Ginn	\$ 35,995.50	\$ 42,479.81
Mosaic-College Park MD	(pastorless)	\$ 7,033.06	\$ 9,057.00
Mosaic-Culpeper	Duane Eatmon	\$ 913.58	\$ 607.48
Mosaic-Hampton Roads	Steve Byrum	\$ 0	\$ 2,826.00
Mount Calvary-Matoaca	Mac Hutton, Interim	\$ 3,728.83	\$ 4,923.31
Mount Carmel-Midland	Peyton Embrey	\$ 2,700.00	\$ 1,800.00
Mount Carmel-Rocky Mount	Todd Barnes, Interim	\$ 500	\$ 500
Mount Eagle-Charlottesville	Sidney Craig	\$ 1,400.00	\$ 3,400.00
Mount Ed-Batesville	Ronald Nickell	\$ 861.12	\$ 2,724.00
Mount Holly-Remington	Chaz Campbell	\$ 10,972.00	\$ 10,298.00
Mount Lebanon-Boston	Dallas Smith	\$ 44,775.00	\$ 24,225.00
Mount Olivet-Copper Hill	Keith Mills	\$ 3,210.00	\$ 3,000.00
Mount Pleasant-Colonial Heights	Curtis Barnes	\$117,657.27	\$168,785.21
Mount Sinai-Galax	Danny Tolley	\$ 645.48	\$ 589.02
Mount Zion-Montvale	William Mitchell	\$ 0	\$ 1,554.32
Mountain View-Blue Ridge	Gary Kingery	\$ 400	\$ 1,300.00
Mountain View-Catawba	Curtis Nester	\$ 2,921.66	\$ 5,485.70
Mountain View-Independence	David Osborne	\$ 17,956.32	\$ 17,507.19
Mountain View-King George	Keith Robinson	\$ 7,962.00	\$ 9,305.00
Movement-Richmond	Cliff Jordan	\$ 6,114.90	\$ 131
Nansemond River-Suffolk	Tim Piland	\$139,697.65	\$140,564.93
Nations United-Richmond	Geriell DeOliveria	\$ 2,292.98	\$ 1,675.43
Natural Bridge-Natural Bridge	Randy Smith	\$ 5,416.58	\$ 4,999.92
New Century-Roanoke	Jay Owens	\$ 4,391.00	\$ 5,139.56
New Hope-Chesterfield	Lee McConnel	\$ 2,602.66	\$ 2,371.95
New Hope-Cross Junction	George Reed	\$ 6,905.00	\$ 7,450.00
New Hope-Gordonsville	Roy Giles	\$ 0	\$ 0
New Hope-Lottsburg	John Penny, Interim	\$ 7,520.54	\$ 8,193.66

Cooperative Program Contributions Comparison, continued

Reference Name	Senior Pastor	2010	2009
New Hope-New Kent	Neil Lieder	\$ 0	\$ 40
New Life-Bedford	Larry Ross	\$ 600	\$ 300
New Life-Ferrum	Jim Walls	\$ 1,200.00	\$ 600
New Life-Louisa	Josh Turner	\$ 10,083.26	\$ 16,499.88
New Life-Ruckersville	Richard Griswold	\$ 0	\$ 0
New Song-Virginia Beach	Donn Cannon	\$ 1,210.00	\$ 1,210.00
Newmarket-Hampton	Skip Hathaway	\$ 2,200.00	\$ 2,600.00
Newville-Waverly	Randy Hawkins	\$ 100	\$ 0
North Bedford-Forest	Chris Brady	\$ 29,851.21	\$ 32,135.92
North Bristol-Bristol	Kenny Bolling	\$ 19,911.30	\$ 15,127.55
North Main-Danville	Rev. Fredrick Unger	\$ 79,203.99	\$ 76,301.77
Northside-Charlottesville	Keith Johnson	\$ 2,600.00	\$ 2,200.00
Northside-Fredericksburg	James Newton	\$ 7,194.85	\$ 7,015.95
NorthStar-Bristol	William Houck	\$ 600	\$ 600
Norview-Norfolk	Michael C.Smith	\$ 19,513.91	\$ 26,286.81
Norwood-Forest	Todd Childers	\$ 3,967.18	\$ 1,394.46
Nueva Esperanza-Richmond	Fernando Mangiei	\$ 641.54	\$ 0
Oak Grove-Big Stone Gap	Mike Jones	\$ 11,432.68	\$ 8,417.95
Oak Grove-Keeling	Mike Myers	\$ 8,000.00	\$ 2,000.00
Oak Grove-Oak Grove	Charles Gibson, Interim	\$ 400	\$ 2,000.00
Oak Grove-Richmond	Andy Rist	\$ 47,827.90	\$ 62,824.27
Oakdale-Madison Heights	Terry Wornstaff	\$ 450	\$ 425
Oakes Memorial-Dry Fork	(pastorless)	\$ 0	\$ 0
Oakton-Chantilly	Lewis Holmes	\$ 14,600.00	\$ 12,000.00
Oasis-Lynchburg	Bubba Rose	\$ 10,363.02	\$ 3,118.01
Old Powhatan-Powhatan	Brad Russell	\$ 5,137.50	\$ 2,750.00
Onancock-Onancock	Sean MacKenzie	\$ 37,292.20	\$ 46,733.36
Onley-Onley	John Burr	\$ 4,400.00	\$ 5,200.00
Open Bible-Roanoke	Marvin Lloyd	\$ 114.67	\$ 356.71
Open Door-Christiansburg	Michael Johnston	\$ 2,575.00	\$ 4,875.00
Open Door-Newport News	David Ryerse	\$ 1,251.00	\$ 1,378.00

Cooperative Program Contributions Comparison, continued

Reference Name	Senior Pastor	2010	2009
Open Door-Sutherlin	Barry Thompson	\$ 0	\$ 250
Palestine-Huddleston	Jackie Carver	\$ 29,575.57	\$ 25,291.42
Parkway-Moseley	Brian Autry	\$131,848.16	\$ 98,881.91
Pathway-Woodlawn	Jeremy Hendrick	\$ 2,351.76	\$ 2,612.19
Pecks-Bedford	Bryan Sheehan	\$ 12,701.00	\$ 15,705.00
Peninsula Korean-Newport News	(pastorless)	\$ 6,000.00	\$ 10,800.00
Petsworth-Gloucester	(pastorless)	\$ 42,000.00	\$ 39,500.00
Pillar-Locust Grove	Jonathan Davis	\$ 900	\$ 450
Pillar-Stafford	Clint Clifton	\$ 2,460.00	\$ 750
Pine Chapel-Hampton	Allen Hopkins, Sr.	\$ 6,326.50	\$ 7,475.36
Pine Grove-Dugspur	(pastorless)	\$ 6,991.75	\$ 5,995.50
Pine Grove-Petersburg	Rodney Jenkins	\$ 609.33	\$ 1,401.00
Pinecrest-Portsmouth	Tom Potter	\$ 93,069.47	\$ 83,801.96
Pioneer-Max Meadows	Neal Hawks	\$ 16,863.40	\$ 13,148.70
Plantation-Roanoke	Ron Young Jr	\$ 1,000.00	\$ 1,000.00
Pleasant Grove-Chesapeake	Bill Keen	\$ 300	\$ 890
Pleasant Grove-Galax	Darrin Brannock	\$ 1,496.27	\$ 2,864.97
Pleasant View-Lynchburg	Ricky Ewing	\$ 52,361.23	\$ 31,038.74
Point-Pantops	Gabe Turner	\$ 5,404.43	\$ 283.50
Poquoson-Poquoson	John Pouchot	\$ 15,047.58	\$ 15,062.93
Potomac-Potomac Falls	Scott Hesler	\$ 14,600.00	\$ 19,000.00
Preston Oaks-Roanoke	Shawn Dobbins	\$ 30,450.97	\$ 28,864.00
Prillaman-Ferrum	Mike Magnan	\$ 1,200.00	\$ 0
Prince George-Prince George	Lewis Garrett	\$ 3,860.03	\$ 3,741.73
Princess Anne-Virginia Beach	Ronald Lee	\$ 28,319.94	\$ 27,033.80
Quaker-Bedford	David Timma	\$ 3,300.00	\$ 3,200.00
Quantico-Quantico	Chris Childers	\$ 625.52	\$ 139.2
Quest-Richmond	Richard Underhill	\$ 516.2	\$ 1,016.11
Radford-Moneta	Don Hicks, Interim	\$ 6,248.13	\$ 15,613.95
Ragland-Sandy Hook	Ed Rodriguez	\$ 6,663.82	\$ 10,753.41
Rainbow Forest-Troutville	Michael Grooms	\$ 7,999.93	\$ 8,004.00

Cooperative Program Contributions Comparison, continued

Reference Name	Senior Pastor	2010	2009
Ramoth-Stafford	Brent Vickery	\$ 40,876.82	\$ 42,379.51
Real Life-Chester	James Srodulski	\$ 9,575.77	\$ 4,641.54
Red Lane-Powhatan	Mike Curry, Interim	\$ 18,750.00	\$ 18,500.00
Redeeming Grace-Lynchburg	Michael O'Brien	\$ 1,166.69	\$ 2,000.04
Redeeming Grace-Mathews	Van Loomis	\$ 894.11	\$ 818.65
Reformation-Lanham	Eric Redmond	\$ 14,332.20	\$ 10,245.19
Remnant-Richmond	Ryan Kidd	\$ 7,831.00	\$ 5,652.00
Renewal-Centreville	Yon Jin Park	\$ 1,501.30	\$ 0
Reservoir-Yorktown	Chris Gill	\$ 10,540.08	\$ 8,304.31
Reston Community-Reston	Matt Morgan	\$ 0	\$ 0
Restoration-DC Metro	Nathan Knight	\$ 2,881.67	\$ 88
Restoration-Hampton	Leonard Riley, Interim	\$ 8,400.00	\$ 8,400.00
Rileyville-Rileyville	Chris Walker	\$ 45,080.16	\$ 58,365.28
River Oak-Chesapeake	Heath Burris	\$ 100,667.63	\$ 67,566.40
River of Life-Franklin	Jeremy Nairn	\$ 1,774.25	\$ 6,834.05
Riverdale-Roanoke	David Jones	\$ 6,189.50	\$ 7,099.00
Riverside-Newport News	Tom Davidson	\$ 5,186.00	\$ 3,442.00
Riverside-Norfolk	Frank Leonard	\$ 14,268.76	\$ 15,549.00
Riverview-Woodbridge	Michael Faulkner	\$ 1,200.00	\$ 0
RiverWay-Midlothian	Phillip Hunt	\$ 0	\$ 0
Roanoke Chinese-Roanoke	Scott Dreyer	\$ 1,609.90	\$ 932.45
Roanoke Deaf-Forest	John Wyble	\$ 745	\$ 798
Roca Eterna-Woodbridge	Manuel Chacon	\$ 7,236.89	\$ 5,266.00
Romanian-Falls Church	Sebastian Muresan	\$ 0	\$ 203.52
Rosedale-Abingdon	Don Paxton	\$ 10,355.80	\$ 8,802.77
Safe Harbor-Bedford	Jerry Parr	\$ 0	\$ 500
Salem-Crozier	Zack Zbinden	\$ 19,250.00	\$ 32,252.00
Salem-Richmond	Thad Key	\$ 1,000.00	\$ 6,916.09
Saltville-Saltville	Wesley Belcher	\$ 1,475.00	\$ 750
Samuel Harris-Chatham	Jerry Smith	\$ 3,165.51	\$ 3,324.75
Sarepta-Blackwater	Carl Johnson	\$ 779.66	\$ 1,109.00

Cooperative Program Contributions Comparison, continued

Reference Name	Senior Pastor	2010	2009
Scenic Park-Bristol	Charles Jones	\$ 2,798.58	\$ 3,011.84
Seaford-Seafood	Dennis Hollandsworth	\$ 2,565.00	\$ 23,691.00
Second-South Boston	Larry Linderman	\$ 12,662.69	\$ 10,356.83
Sedalia-Big Island	Mike Jones	\$ 0	\$ 0
Seed International-Richmond	Henry Amedeker	\$ 332	\$ 443.1
Shady Grove-Thaxton	Harry Leland	\$ 11,238.11	\$ 10,644.12
Sharon-Rural Retreat	Jack Rutherford	\$ 5,234.00	\$ 4,000.00
Shenandoah-Shenandoah	Hudson Nuckols Jr	\$ 2,400.00	\$ 2,800.00
Shenandoah-Stephens City	Eric Farel	\$ 0	\$ 2,400.00
Shenandoah-Waynesboro	Paul LaPrevotte	\$ 7,939.19	\$ 17,665.49
Shenandoah-Woodstock	Banks Swanson	\$ 24,459.47	\$ 22,398.84
Shermont-Danville	Ryan Riley	\$ 6,441.32	\$ 5,413.03
Shiloh-Carson	Hugh Mayes	\$ 3,510.52	\$ 5,180.47
Sky View-Fancy Gap	Wendell Horton	\$ 36,170.62	\$ 38,457.56
Smith Memorial-Williamsburg	Ron Wade	\$ 58,372.27	\$ 62,334.96
Smyrna-Dinwiddie	Robert Rowland III	\$ 38,082.50	\$ 38,288.00
Snow Hill-Galax	Ernie Smith	\$ 6,000.00	\$ 6,458.33
Sonlight-Chesapeake	Hershel Adams	\$ 25,009.00	\$ 19,977.95
SonRise-Virginia Beach	Steven Smith	\$ 7,301.00	\$ 6,605.00
Soul Purpose-Beaeton	Matt Gregory	\$ 7,316.00	\$ 9,168.91
South Anna-Mineral	Steven McClary	\$ 0	\$ 2,030.47
South Fork-Marion	Mark Totten	\$ 4,800.00	\$ 4,985.21
South Norfolk-Chesapeake	David Slayton	\$ 20,578.00	\$ 23,884.00
South Quay-Suffolk	John Watson	\$ 4,000.00	\$ 4,000.00
Southside-Richmond	Dennis Tucker	\$ 22,110.87	\$ 24,012.71
Southside-South Boston	Don Bryant	\$ 3,231.25	\$ 1,000.00
Southside-Suffolk	Stewart McCarter	\$ 110,842.85	\$ 82,198.69
Sovereign-Spotsylvania	Jay Flickinger	\$ 100	\$ 100
Spears Mountain-Gladstone	Odell Coggins	\$ 1,125.00	\$ 1,500.00
Spotswood-Fredericksburg	Drew Landry	\$ 275,111.48	\$ 269,367.09
Spotsylvania-Spotsylvania	Jeff Parsons	\$ 5,600.37	\$ 3,709.79

Cooperative Program Contributions Comparison, continued

Reference Name	Senior Pastor	2010	2009
Spout Spring-Spout Spring	Paul Kvasnicka	\$ 3,271.96	\$ 2,758.42
Stafford-Stafford	Bill Jessup	\$ 21,999.60	\$ 21,499.71
Staples Mill-Glen Allen	Jim Booth	\$ 62,380.19	\$ 44,140.14
Staunton River-Nathalie	Andy Ferguson	\$ 8,167.64	\$ 5,847.12
Staunton-Huddleston	Bill Ireland, Interim	\$ 4,500.00	\$ 2,000.00
Stevensburg-Stevensburg	Philip Walker	\$ 15,293.00	\$ 15,645.75
Stokesland-Danville	Charles Vickers	\$ 14,505.00	\$ 5,000.00
Suck Spring-Bedford	Michael Cox	\$ 13,665.21	\$ 13,732.58
Sugar Grove-Sugar Grove	Billy Gwinn	\$ 7,528.65	\$ 6,620.38
Sumerduck-Sumerduck	(pastorless)	\$ 400	\$ 800
Sunrise-Arlington	John Maritim	\$ 435	\$ 178
Sutherland-Sutherland	(pastorless)	\$ 0	\$ 0
Swagath-South Asia	Anante Shinde	\$ 0	\$ 0
Swift Creek-Colonial Heights	Steve Felker	\$ 41,889.61	\$ 43,541.07
Swift Creek-Midlothian	Ronnie Brown	\$168,561.93	\$164,714.38
Symphonic-Norfolk	Ron Jones	\$ 0	\$ 900
Tabernacle-Danville	Lamarr Mooneyham	\$ 70,200.00	\$ 64,800.00
Tabernacle-Newport News	Wes Taylor	\$ 29,817.25	\$ 26,507.09
Ten Talents-Falls Church	Andrey Shirin	\$ 702.10	\$ 802.40
Thomas Road-Lynchburg	Jonathan Falwell	\$ 6,000.00	\$ 6,000.00
Thornburg-Thornburg	Danny Lester	\$ 4,677.00	\$ 4,346.00
Three Rivers-West Point	John Koch	\$ 4,771.77	\$ 3,675.39
Timber Ridge-Bedford	Rick Foster	\$ 21,544.24	\$ 27,110.85
Travelers-Spotsylvania	Clyde Coleman	\$ 12,000.00	\$ 12,500.00
Trinity-Bedford	Vernon DeLong	\$ 11,607.00	\$ 12,989.00
Trinity-Hampton	Carlton Shrieves	\$ 2,202.00	\$ 2,387.00
Troutdale-Troutdale	Kenny Riggins	\$ 866.64	\$ 418.16
True Course-Virginia Beach	Bert Kirk	\$ 1,260.52	\$ 721.30
Tsena Commocko-Providence Forge	Bi-Vocational	\$ 5,266.53	\$ 4,878.57
Tucker Swamp-Zuni	Bill Dawson, Interim	\$ 44,883.00	\$ 45,391.00
Tussekiah-Meherrin	Greg Noland	\$ 3,689.88	\$ 2,746.59

Cooperative Program Contributions Comparison, continued

Reference Name	Senior Pastor	2010	2009
Twin Oaks-Ferrum	Terry Covey	\$ 3,000.00	\$ 3,000.00
Union Chapel-Lynch Station	Chad Miller	\$ 4,003.56	\$ 2,595.24
Union-Chincoteague	Kevin Eley	\$ 43,007.34	\$ 43,099.81
Union-Hayes	(pastorless)	\$ 27,607.46	\$ 9,013.28
Upperville-Upperville	Bill Wennersten	\$ 2,600.00	\$ 2,600.00
Valley Street-Abingdon	William Austin	\$ 1,831.61	\$ 3,862.06
Valley View-Bristol	Kenneth Widner	\$ 2,400.00	\$ 2,400.00
Victory-Stafford	John Hodgen	\$ 3,200.00	\$ 0
Vida Nueva-Richmond	Diego Fernandez	\$ 0	\$ 0
Village-Midlothian	Stephen Gentry	\$ 2,681.97	\$ 2,265.58
Virginia Beach Beacon-Virginia Beach	Gordon Ellsworth	\$ 23,189.38	\$ 23,682.51
Walters-Partlow	James Graham	\$ 4,054.46	\$ 4,827.53
Walnut Grove-Bristol	Carl Young	\$ 6,408.50	\$ 6,188.00
Walnut Grove-Montvale	Harold Lewis	\$ 1,000.00	\$ 500
Warwick-Newport News	Robert Wilson	\$ 2,076.90	\$ 4,854.94
Water's Edge-Clarksville	John Bohannon	\$ 825	\$ 375
Waters Edge-Yorktown	Stuart Hodges	\$ 21,000.00	\$ 21,000.00
Waverly-Waverly	(pastorless)	\$ 12,929.00	\$ 12,563.36
Wayne Hills-Waynesboro	Danny Campbell	\$ 58,716.51	\$ 56,920.69
West End-Richmond	Joe Tanner	\$ 14,465.97	\$ 15,306.63
West Salem-Salem	Nick Shaffer	\$ 250	\$ 660.71
Western Branch-Portsmouth	Walter Black	\$ 34,309.16	\$ 29,628.68
Western Heights-Petersburg	Jonathan Dundalow	\$ 39,677.80	\$ 3,075.69
Westlake-Moneta	Justin Likens	\$ 1,000.00	\$ 0
Westmont-Johnstown PA	John Brownlee	\$ 10,372.87	\$ 10,276.00
Westwood-Waynesboro	David Huffer	\$ 5,632.48	\$ 8,574.39
White Rock-Hardy	Joe Green	\$ 5,451.50	\$ 6,311.37
Willis Memorial-Cascade	J Haywood Alcorn	\$ 1,100.00	\$ 2,300.00
Willow-Barboursville	William Templeton	\$ 2,000.00	\$ 2,000.00
Windsor Hills-Roanoke	Lawrence Dodson	\$ 7,000.00	\$ 13,000.00
Winn's-Glen Allen	Jeff Brauer	\$ 52,000.00	\$ 47,600.00

Cooperative Program Contributions Comparison, continued

Reference Name	Senior Pastor	2010	2009
Woodlawn-Alexandria	Travis Hilton	\$ 3,697.00	\$ 6,778.00
Woodlawn-Danville	Curtis Faison	\$ 24,213.12	\$ 27,844.50
Woodlawn-Hopewell	Ken Hendricks	\$ 33,050.00	\$ 12,700.00
Worsham-Farmville	Ken Jones	\$ 15,286.70	\$ 13,672.74
York River-Williamsburg	Bill Cashman	\$ 11,875.00	\$ 16,377.19
Zion Hill-Fincastle	Donnie Scarlett	\$ 4,000.00	\$ 4,000.00
Zion-Orange	Daryl Harbin	\$ 15,641.33	\$ 17,651.36
TOTAL COOPERATIVE PROGRAM		\$ 8,812,176.99	\$ 8,975,943.58

2010 Vision 20/20 Steering Team Report

In its January 2009 meeting, the Executive Board of the Southern Baptist Conservatives of Virginia (SBCV) voted unanimously to form a task force to “review the SBCV’s past, examine its present, and envision a preferred future that would bring our God great glory.” Members of that group included:

SBCV Convention Officers:

Tim Hight (Main St., Christiansburg), President
Mike Palmer (Green Ridge, Roanoke), 1st Vice-President
Brian Autry (Parkway, Moseley), 2nd Vice-President
Mike Smith (Norview, Norfolk), Secretary

SBCV Leadership Team:

Jeff Ginn, Executive Director
Doyle Chauncey, President of the SBCV Foundation and Church Ministry Services
Steve Bradshaw, Director of Maturing Churches
Mark Custalow, Director of Multiplying Churches
Mark Gauthier, Director of Mobilizing Churches

At Large Representatives:

Gordon Ellsworth (Virginia Beach Beacon), Executive Board member
Daniel Floyd (Lifepoint, Fredericksburg)
Wendell Horton (Sky View, Fancy Gap), Executive Board member
Clovis Pause (Iglesia El Camino, Richmond)
Amy Stewart (Beaverdam), Executive Board member
Jim Stone (Spotswood, Fredericksburg), Executive Board member
Carl Weiser (Hyland Heights, Lynchburg), Executive Board member & Chairman

In November 2009 the task force presented to the Annual Homecoming their report. The report, which was approved unanimously, centered on six key components. Additionally, the report proposed the formation of a steering team that would spend the next year collaborating with state staff on the development of strategies and the implementation of the six key components. The steering team was composed of the following members:

Brian Autry
Daniel Floyd
Wendell Horton
Amy Stewart
Carl Weiser (Chairman)

The steering team celebrates that significant strides have been made with respect to the original goals of the Vision 20/20 plan. Here is a restatement of those goals with updates on each:

1. A multiplying missional network . . . in which the number of congregations grows from over 500 to over 1000, including the planting of 400 new congregations.
 - a. Approximately 23 new churches were added this year by affiliation.
 - b. Approximately 17 new church planters and 9 new church planter apprentices were approved for church planting work.
 - c. Significant demographic studies were commissioned to identify pockets of lostness that will become primary targets for new church starts.
 - d. A major initiative in lay church planting is being developed that will be an additional church planting strategy.

- e. Development of ethnic church planting movements is underway.
- 2. A maturing missional network ... in which at least 500 congregations progress to the next level of congregational health.
 - a. This goal will be pursued through the provision of church health assessments and seminars.
 - b. Pastoral and staff growth opportunities will be provided. These include the 18 “Connections” statewide, 50 “Power Meals” statewide, and personalized mentoring that are regularly offered.
 - c. Lay leader training (E-412 and Customized) will be provided.
 - d. Outreach and evangelism tools (E-412, block parties, servant evangelism, GPS, etc.) are made available to churches and church plants.
- 3. A mobilizing missional network ... in which the number of congregations committed to the Acts 1:8 Challenge grows from approximately 50 to over 500.
 - a. There has been an increase of more than 50% in the number of churches participating in the *Acts 1:8 Network*.
 - b. Five churches have agreed to be Network Leaders as a part of the Acts 1:8 Network, leading network churches that focus on peoples in Vietnam, Haiti, El Salvador, North Africa, and Burkina Faso.
 - c. Job descriptions for Missionary Service Corps positions for Acts 1:8 Ministry Region Coordinators have been developed.
 - d. The Partnerships Associate position was increased from part-time to full-time. It includes serving as the Acts 1:8 Network Coordinator.
- e. Several additional strategies have been outlined:
 - i. 36 churches have been identified for enlistment in the Acts 1:8 Network over the next 6 months.
 - ii. A goal has been established to enlist 1-2 MSC missionaries each year for the next 3 years to assist in educating churches about the Acts 1:8 Network.
 - iii. A goal has been established to contact 6 churches per month to promote Acts 1:8.
- 4. A sacrificial missional network ... in which ever greater resources are channeled to national and international mission causes through the Cooperative Program.
 - a. The process of allotting an additional 0.25% of CP monies to SBC causes has been effectively implemented.
 - b. The process of securing a cost-effective facility to house our mission support center is underway.
 - c. Media services are helping to develop CP promotional materials for a nationwide effort.
 - d. The state missions offering has been rebranded as Vision Virginia. The goal has been raised significantly so that more resources can be generated to meet the ministry objectives of the SBCV.
- 5. A streamlined missional network ... in which the decentralized model of ministry for which the SBCV is noted nationally will be furthered so that the state convention becomes even more accessible to the local church

- a. Structure
 - i. The SBCV has consolidated into five regions with approximately 50 clusters statewide.
- b. Schedule
 - i. The events calendar has been streamlined with an emphasis on a major statewide Spring event (E412) and a major statewide Fall event (Annual Homecoming).
 - ii. There is an increase in partnering with existing churches in approved conferences.
 - iii. The SBCV has reduced the number of monthly staff meetings of state missionaries and reduced the number of Executive Board meetings at GAMSC. These two moves have resulted in significant savings.
- 6. A contextualized missional network... in which the timeless principles of God's word are communicated effectively in the ever-changing culture in which we live.
 - a. State missionaries tailored GPS for our context.
 - b. Leadership development centers that will provide contextualized training for church planters and leaders are being developed.
 - c. There is an ongoing examination of our state convention's branding.

The financial realities of our national and local economies are in stark contrast to the growing spiritual opportunities that surround us. The slow national economy and the reduction of funding from national partners combine to make it more challenging to address the acute ministry needs that exist. A

recent study revealed that 7 out of every 10 people living in Virginia are spiritually lost.

It is our prayer that the increased generosity of the SBCV to national and international mission causes will result in a greater commitment on the part of our churches to our cooperative missions efforts. We pray that every church will raise the percentage of its giving to the Cooperative Program. We pray that every church will grow both spiritually and numerically all to the glory of God.

Church Affiliation Report

SBCV Annual Homecoming, November 7-9, 2010

Churches Requesting Affiliation:

Central-East

Fellowship Community Church	Mechanicsville	Rev. Tony Ramirez	Unique
Journey Christian Fellowship	Quinton	Rev. Greg Pulling	Unique
Newville Baptist Church	Waverly	Rev. Randy Hawkins	Unique
Second Chance Baptist Church	Prince George	Rev. David Prather	Unique

Central-West

Catawba Baptist Church	Nathalie	(pastorless)	Unique
ClearView Church	Fishersville	Rev. John Hamric	Unique
Grace Baptist Church	Madison Heights	Rev. Jeff Slaughter, Interim	Unique
Redeemer Baptist Church	Lynchburg	Rev. John Barrett	Unique
Restoration Family Church	Lynchburg	Rev. Joshua Solovskoy	Unique
Tabernacle Baptist Church	Salem	Rev. Richard Elmore	Unique

North

All Nations SaRang Church	Centreville	Dr. Seong Soo Kim	Unique
Apple Valley Baptist Church	Berryville	Rev. Van Welton	Unique
Broad Run Baptist Church	Warrenton	Rev. Larry White	Unique

Southeast

Calvary Evangelical Baptist Church	Portsmouth	Dr. Allen McFarland	Unique
Fox Hill Road Baptist Church	Hampton	Rev. Tommy Larson	Dual
Green Lakes Baptist Church	Portsmouth	Dr. Dwight Buchholz	Unique

Changing from Dual to Unique:

North		
Calvary Baptist Church	Orange	Dr. Richard Groble
Hatcher's Memorial Baptist Church	Bristow	Rev. C. Wesley Conner

Merged:

Mount View Baptist Church, Bluefield merged with Crosspointe Community Fellowship, Bluefield.

Salem Baptist Church, Virginia Beach merged with Essential Church, Virginia Beach.

Yorkminister Baptist Church, Yorktown merged with Reservoir Community Church, Newport News.

Withdrawing this Year:

Iglesia Bautista Hispana Columbia	Falls Church	Mr. Julio Ruiz
Korean Columbia Baptist Church	Falls Church	Rev. Sam Choi
Lower Rapidan Baptist Church	Rapidan	(pastorless)
Symphonic Church	Chesapeake	Rev. Ron Jones

Dissolved:

Fairways Community Church	Haymarket
Fellowship Baptist Church	Petersburg
Mosaic	Wytheville
Northside Korean Baptist Church	Charlottesville
Sutherland Christian Fellowship	Dinwiddie

Recommendation:

The Executive Board recommends to the messengers in the 2010 Annual Homecoming that churches requesting affiliation in this year's meeting be enthusiastically received into the SBCV.

Total Affiliations:

Uniquely: 452
Dually:46
Church Plants: 66
Withdrawing this year: 4
Dissolved: 5
Total Affiliated: 568

2010 Nominating Committee Report

2011 Executive Board

Central-East Region (6)

Rev. Donald Joyner (Matoaca-Matoaca) 2012
Dr. Randy Hahn (Colonial Heights-Colonial Heights) 2011
Rev. Roger McNiel (Swift Creek-Midlothian) 2011
Rev. Robert Rowland (Smyrna-Dinwiddie) 2013
Mrs. Amy Stewart (Beaverdam-Beaverdam) (L) 2011
Mr. Tony Sendaydiego (Parkway-Moseley) (L) 2012

Central-West Region (9)

Rev. Rick Ewing (Pleasant View-Lynchburg) 2013
Rev. Carl Weiser (Hyland Heights-Rustburg) 2011
Dr. Bryan Smith (First-Roanoke) (N) 2013
Rev. Joey Bray (The Tabernacle-Danville) 2012
Rev. David Rathel (Fork-Scottsburg) (N) 2013
Mrs. Teresa Sours (Wayne Hills-Waynesboro) (L) 2013
Rev. Doug Ramsey (Hillcrest-Ridgeway) 2011
Mr. Wayne Sink (Preston Oaks-Roanoke) (L) 2011
Mr. Jim Looney (Craig Valley-New Castle) (L) 2011

North Region (4)

Dr. Daryl Harbin (Zion-Orange) (N) 2013
Rev. Jim Stone (Spotswood-Fredericksburg) 2011
Rev. Bill Hatcher (Centreville-Centreville) 2011
Rev. Eliezer Perez (Iglesia-Manassas) 2012

Southeast Region (8)

Rev. Jonathan Carpenter (Exmore-Exmore) 2012

Rev. Randy Green (Harvest Fellowship-Smithfield) 2013
Mr. Arthur Leary (Liberty-Hampton) (L) 2013
Rev. Curt Breland (First-Norfolk) 2011
Rev. Stewart McCarter (Southside-Suffolk) 2012
Mrs. Sharon Piland (Nansemond River-Suffolk) (L) 2011
Rev. Dennis Hollandsworth (Petersworth-Gloucester) 2013
Rev. Gordon Ellsworth (VA Beach Beacon-VA Beach) 2012

Southwest Region (3)

Rev. Neal Hawks (Pioneer-Max Meadows) 2011
Rev. Wendell Horton (Sky View Missionary-Fancy Gap) 2012
Rev. Lonnie Brooks (East Stone Gap-East Stone Gap) 2012

Key: (L) Layperson (N) New

2010 Nominating Committee:

Dr. Kelly Burris (Kempsville-Virginia Beach)—Chairman
Rev. Jackie Carver (Palestine-Huddleston)
Dr. Tom Lovorn (God's Storehouse-Chesterfield)
Rev. Clint Clifton (Pillar-Stafford)
Dr. Mike Palmer (Green Ridge-Roanoke)
Dr. Wayne Guynn (First-Damascus)

Recommendation:

The Nominating Committee recommends to messengers in the 2010 Annual Homecoming that persons nominated in this year's meeting be approved to serve on the 2011 Executive Board of the SBCV. Note: Term expires at the end of the Annual Meeting of the year indicated.

Nominating

Dr. Kelly Burris (Kempville-Virginia Beach)—Chairman

Rev. Jackie Carver (Palestine-Huddleston)

Rev. Clint Clifton (Pillar-Stafford)

Dr. Wayne Guynn (First-Damascus)

Dr. Tom Lovorn (God's Storehouse-Chesterfield)

Dr. Mike Palmer (Green Ridge-Roanoke)

Resolutions

Rev. Paul Davis, Jr. (First-St Charles)--Chairman

Rev. Bruce Goldsmith (Laurel Hill-Earlysville)

Rev. Michael Harrison (The Community Fellowship-Collinsville)

Rev. Cliff Jordan (Movement Church-Richmond)

Rev. Greg Palmer (North Main-Danville)

Dr. Cary Paulk (Bayview-Norfolk)

Credentials

Dr. Philip Parker (Calvary-Portsmouth)

Rev. Joey Craft (Restoration Church-Washington,DC)

Rev. Shawn Dobbins (Preston Oaks-Roanoke)

Rev. Bill Grindstaff (Craig Valley-New Castle)

Rev. Brad Russell (Old Powhatan-Powhatan)

Rev. David Timma (Quaker Baptist-Bedford)

Ushers/Tellers

Rev. Gary Vaughn(Nansemond River-Suffolk)

Rev. Tim Chrisman(Little River-Bumpass)

Rev. Bruce Cole (Hopeful-Montpelier)

Rev. Curt Faison (Woodlawn-Danville)

Rev. George Rose (Oasis Church-Amherst)

Rev. Bryan Sheehan (Pecks-Bedford)



SBC of Virginia Business and Ministry Plan

Organization and Purpose:

The Southern Baptist Conservatives of Virginia (SBCV or “the Convention”) is an autonomous state convention cooperating with the Southern Baptist Convention. The SBCV has two wholly owned subsidiaries: (1) SBCV Church Ministry Services, Inc. (CMS) and (2) SBC of Virginia Foundation, Inc. (FDN). CMS is funded by the SBCV and supports the overall purpose of the SBCV primarily by extending loans from available funds and providing payroll and accounting services to qualifying churches and church plants. The FDN supports the overall purpose of the SBCV by encouraging church members and other individuals to include the local church, SBCV, and SBC ministries in their personal financial estate plan. The FDN also serves as trustee of investment funds from SBCV churches and church plants. The SBCV and its subsidiaries are non-stock Virginia Corporations recognized by the Internal Revenue Service as not for profit 501(C)(3) religious organizations.

Regions:

The state of Virginia is presently divided into five strategic regions (1) Central-East, (2) Central-West, (3) North, (4) Southeast, and (5) Southwest. Churches in areas surrounding Virginia, including the District of Columbia, may request affiliation with the SBCV. If approved, they will be included in the closest Virginia region.

State Missionaries:

Each region is served by at least one Church Health Strategist, one Church Planting Strategist, and multiple part-time associate strategists based on the population of churches within the region and available funds. Strategists and associate strategists are strategically located near SBCV churches throughout the five (5) regions. They are responsible for establishing goals and implementing action plans to accomplish the three strategic objectives of the Convention: (1) Multiplying Churches, (2) Maturing Churches and (3) Mobilizing Churches. A Director for each strategic objective is responsible for leading strategists and associates in their assigned area of responsibility.

Missions Support Center Teams:

The Missions Support Center Teams are Ministry Services and Media Services that operate from a central location located in Glen Allen, Virginia to assist and support the state missionaries and affiliated churches. Ministry Services include Resource Services, Business Services and Information Services. Media Services consist of graphics design, website and electronic media.

Executive Board:

In accordance with the Constitution and Bylaws, the Executive Board includes regional representatives, officers of the convention, and the Executive Director-Treasurer. The Board has an Executive Committee with five committees. The responsibilities of each committee are outlined in the Committee Administration Manuals.

- A. Multiplying Churches
- B. Maturing Churches
- C. Mobilizing Churches
- D. Ministry Services
- E. Media Services



Executive Committee:

In accordance with the Constitution and Bylaws, the Executive Committee acts on behalf of the Executive Board between Board meetings. The Executive Committee is composed of the following officers: Convention Officers (4), Chairman of the Executive Board (1), Chairmen of the Standing Committees (5), and the Executive Director.

Regional Representation:

The Executive Board will consist of the Convention Officers and elected representatives from every Region not to exceed 30 members plus the Convention Officers. Regional representation will be based on the average worship attendance within the Region, and every region is eligible for a minimum of three (3) Board members. Average worship attendance in excess of 5,000 in a church will not be included in the total used for determining the number representatives from a region. Every region is eligible for an additional Board member representative for every 5,000 in average worship attendance above 5,000.

Cooperative Program of the SBCV:

Financial resources for missions and ministries in Virginia, North America, and around the world come from the generous and faithful financial gifts to the Cooperative Program from churches affiliated with SBCV. In keeping with the original intent of the framers of the Cooperative Program in 1925, SBCV distributes a minimum of 50% of all undesignated gifts received from its affiliated churches to the Southern Baptist Convention. The Convention shall manage all designated gifts to be held separately for the purpose for which they were given. All such designated gifts shall be recorded in the Convention books and forwarded to the designated ministries. The Convention shall have

the right to return any gift received from any source not in keeping with the Constitution and Bylaws. The Executive Board shall approve a list of entities and individuals to which the Convention will forward designated gifts. Cooperative Program and designated gifts will be disbursed immediately after closing of the books each month, no later than the 15th day of the following month.

Solicitation of Funds:

Recipients of Cooperative Program funds may not directly solicit SBCV churches in any fund raising programs without receiving prior approval from the Executive Board.

Amendments:

This Business and Ministry Plan may be amended by two-thirds (2/3) vote of the Executive Board. Approved by Executive Board October 6, 2009

NOTES

THE SOUTHERN BAPTIST CONSERVATIVES OF VIRGINIA

4101 COX ROAD, SUITE 100 • GLEN ALLEN, VA 23060

Ph: (888) 234-7716 • Fax: (804) 270-1834

WWW.SBCV.ORG

Transforming LIVES

Hyland Heights Baptist Church

Lynchburg

November 7-9, 2010

